

Shema de amplasament Sc 1:25 000

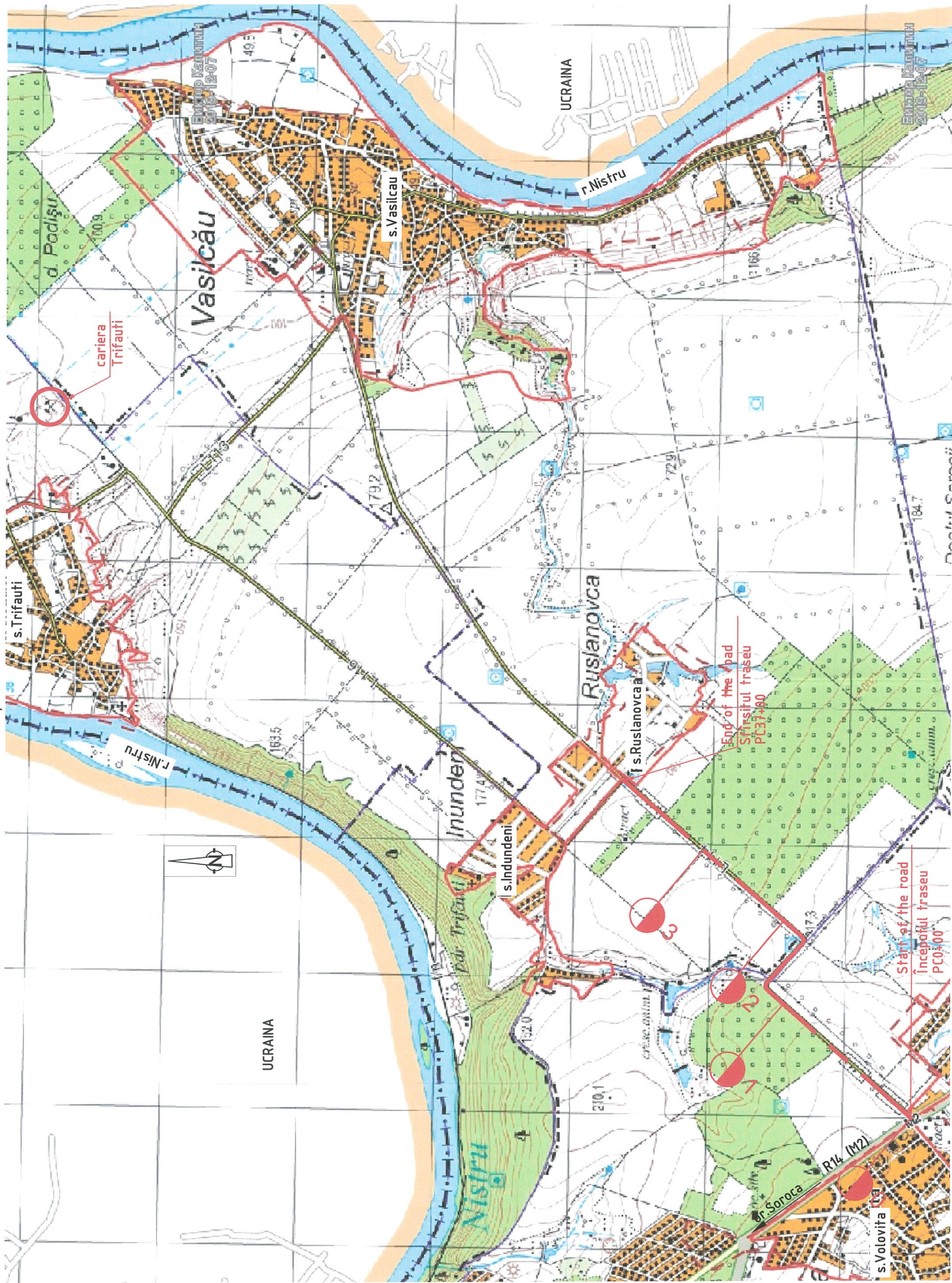

Mhd. N° poda	Ilocn. u dama	Basm. uhd. N°
--------------	---------------	---------------

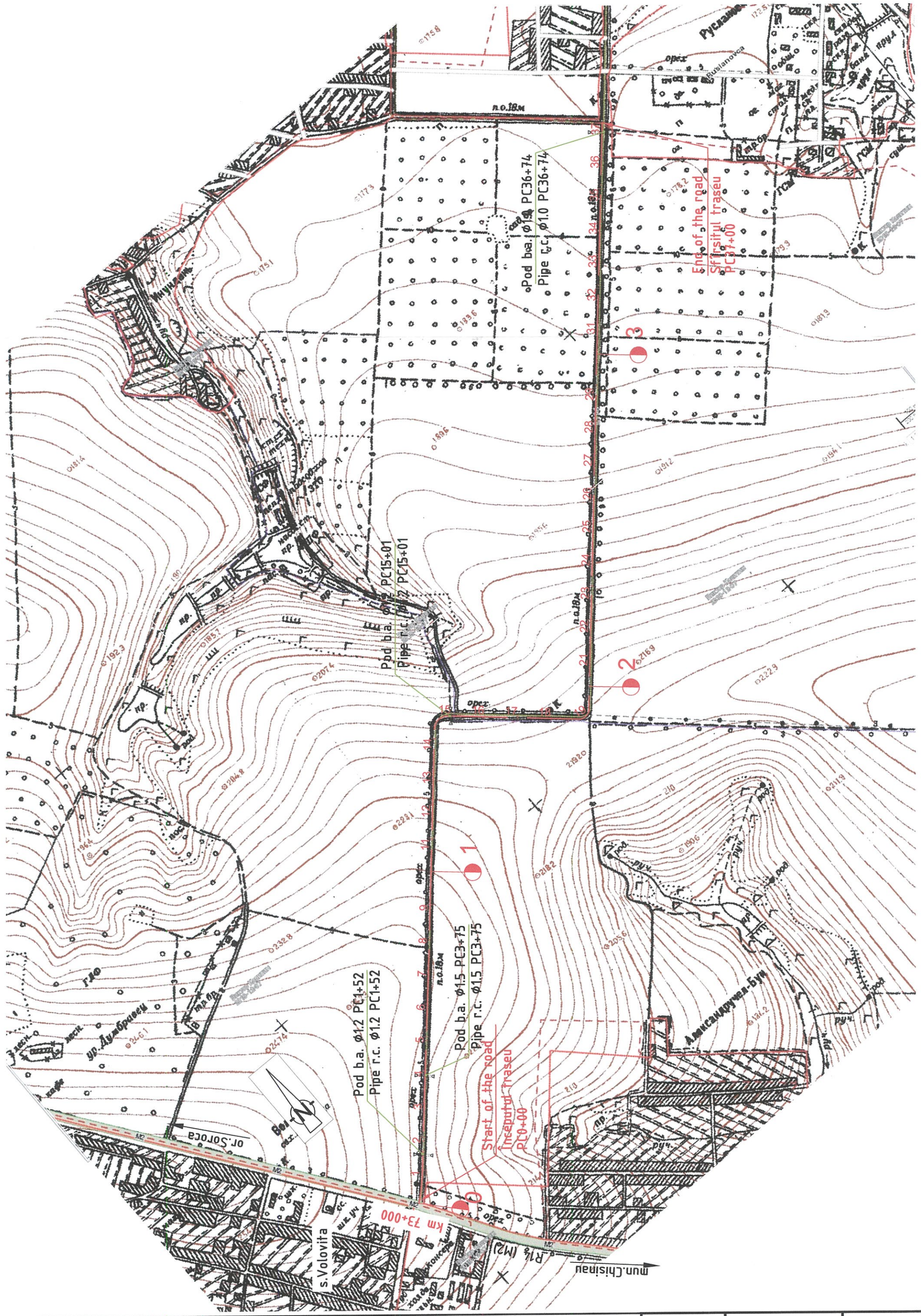

Nhd. N. podn.	Ilozn. u. dama.	Bazm. uhd. N.
---------------	-----------------	---------------

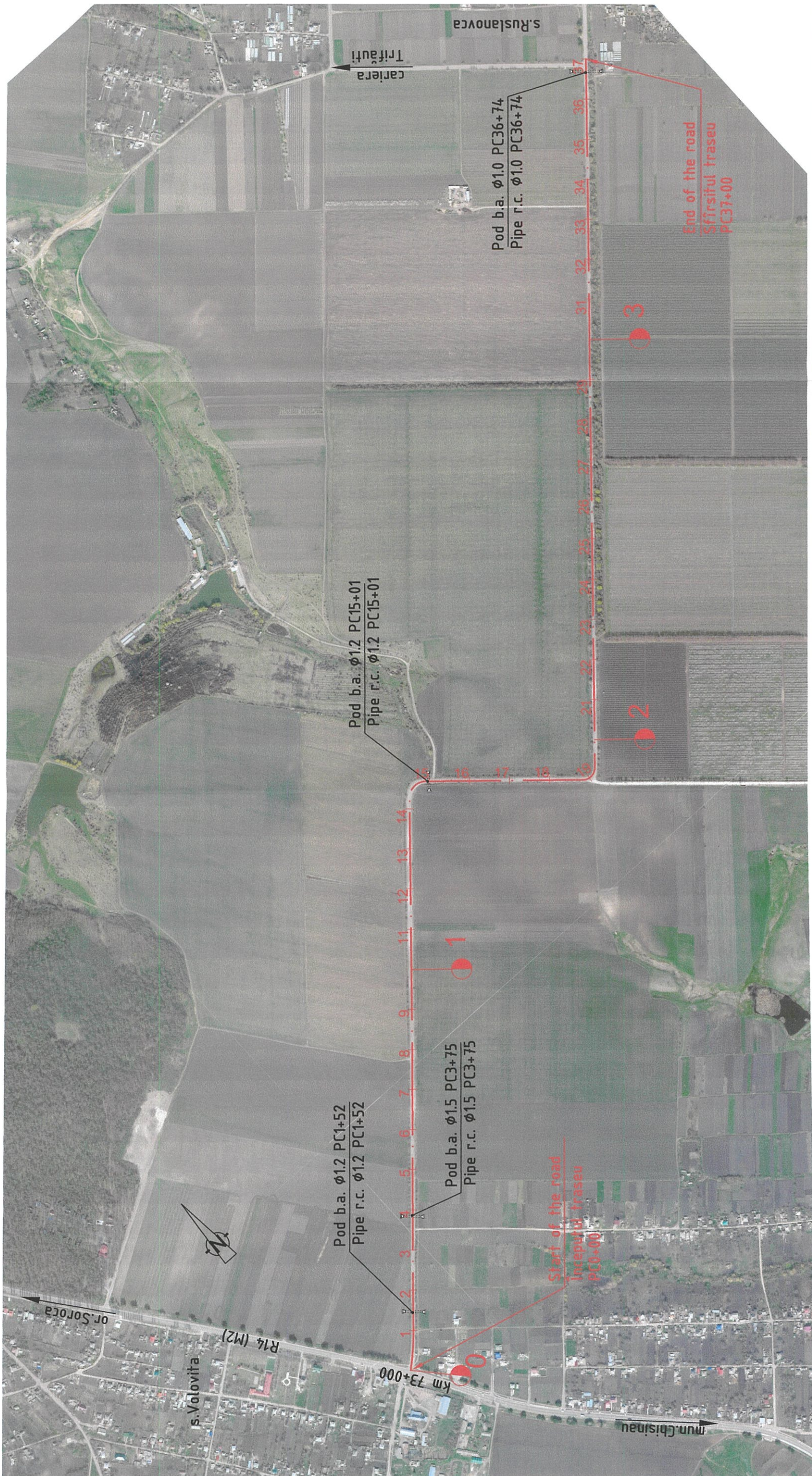

13-DA

"Serviciu privind elaborarea studiului de fezabilitate pentru executarea lucrărilor de reparație capitală a drumului public local L103 Volovița - Vasilcău în cadrul proiectului „Drumuri bune și accesibile în comuna Comarna, Județul Iași, România și comuna Vasilcău, raionul Soroca, Republica Moldova”

Mod	Nºsec	Planșa	Nºdoc	Semnăt	Data
ISP		Carir-ă			12.19
Verificat		Calitin			12.19
Elaborat		Carir-ă			12.19

Faza	Planșa	Planse
SF	4	

Plan traseu PC 0+00-PC37+00

CĂD
EXPERT

TIP 1
PC0+00-PC0+50

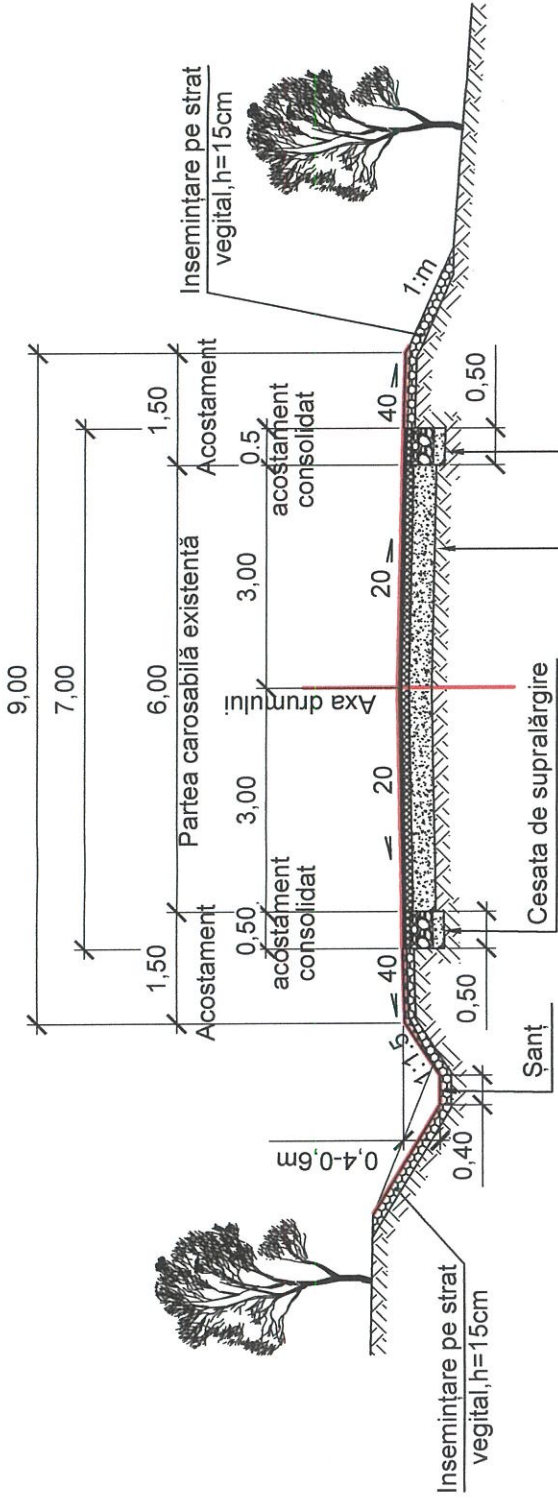

- Balast (amestec din nisip și prundiș) - 0,15
- Strat de fundație din amestec C4 din prundiș M800 - 0,30
- ȘKPg – I SM STB 1033:2008 - 0,06
- ȘMBg – II/2,3 SM STB 1033:2008 - 0,04

- Îmbrăcămintă rutieră existentă
- Strat de uzură din beton asfatic microgranular dens
- ȘMBg – II/2,3 SM STB 1033:2008 - 0,04

TIP 2
PC0+50-PC37+00

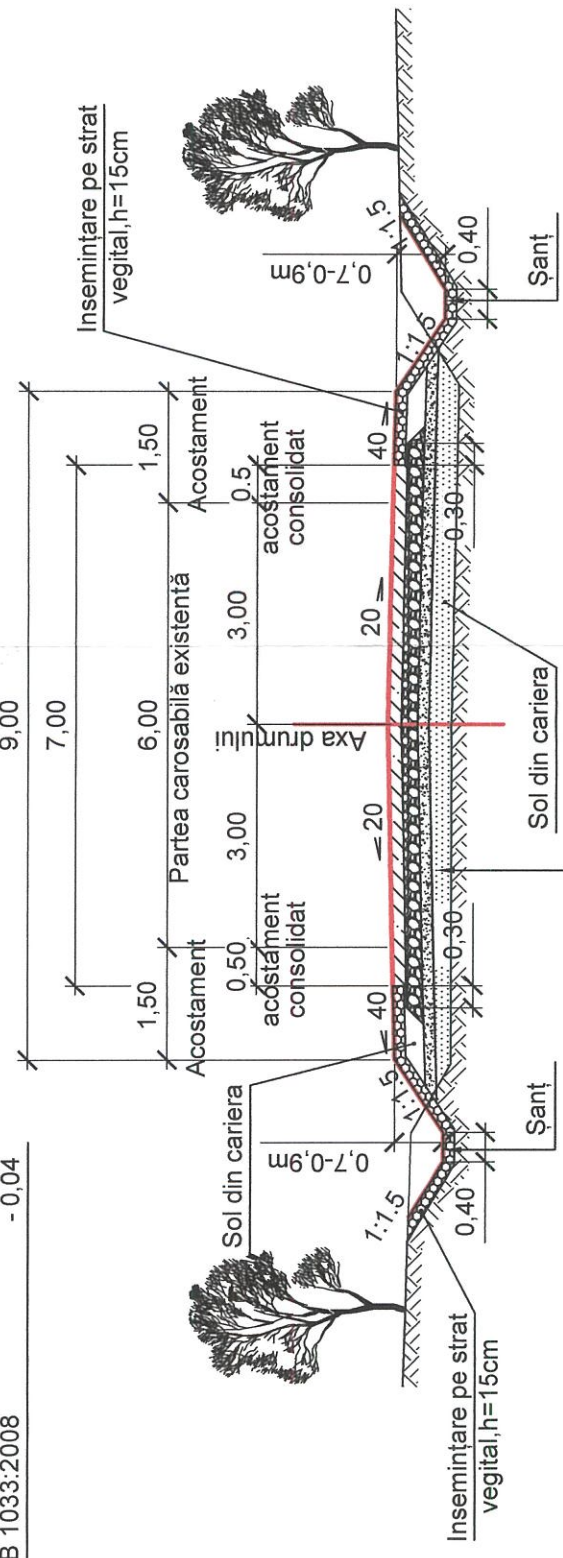

- Balast (amestec din nisip și prundiș) - 0,15
- Strat de fundație din amestec C4 din prundiș M800 - 0,22
- Beton monolit B30, F200, W6 Bbtb 3,6 - 0,18

13-DA

"Serviciu privind elaborarea studiului de fezabilitate pentru executarea lucrărilor de reparație capitală a drumului public local L103 Volovița - Vasilcău în cadrul proiectului „Drumuri bune și accesibile în comuna Comarna, județul Iași, România și comuna Vasilcău, raionul Soroca, Republica Moldova”

Mod	Nºsec	Planșa	Nºdoc	Semnăt	Data
IȘP		Cariera			12/19
Verificat		Calitin			12/19
Elaborat		Cariera			12/19

Profile transversale tip a terasamentului:
TIP 1,2

CĂD
EXPERT

Start of the road PC0+00
 Începutul traseu PC0+00
 x-329444,931 y-194770,074

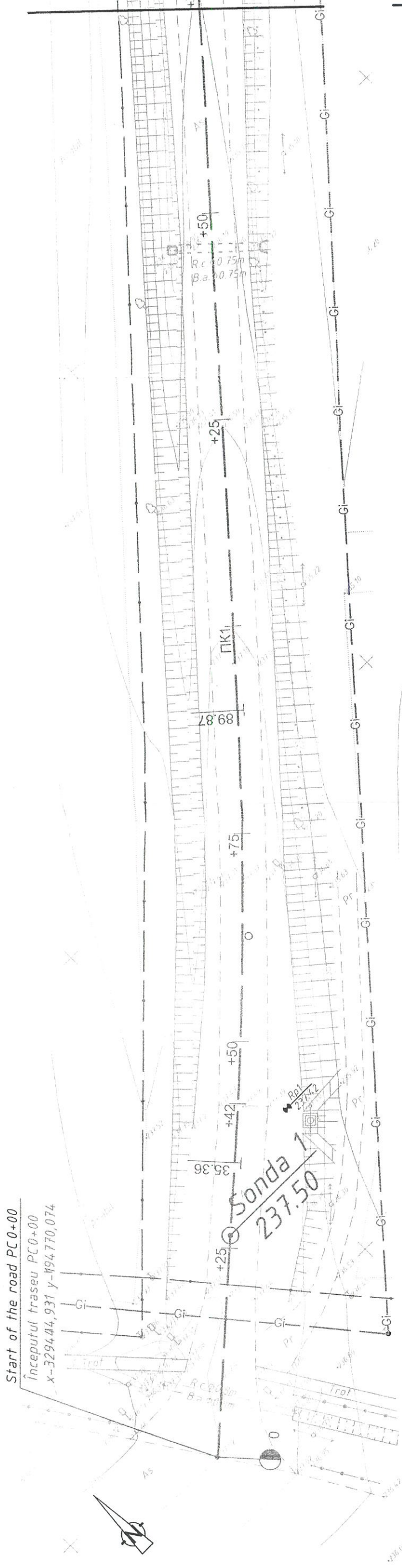

Linia de racordare cu planşa Nr.3 la PC 3+60
 Match line with sheet Nr.3 on PC3+60



REPUBLICA MOLDOVA
 CONSILIUL RAIONAL SOROCA
 COPIA ESTE CONFORMA
 CU ORIGINALUL
 secretar al Consiliului Raional Soroca

Legenda

- Son.1 Sonda de foraj, nr.
- 237.50 Cota gurii

114-DA

"Serviciu de elaborare a proiectului tehnic pentru repararea și amenajarea drumului public local L103 Volovița - Vasilcău, km 0+000-3+700, în cadrul proiectului „Drumuri bune și accesibile în comuna Comarna, județul Iași, România și comuna Vasilcău, raionul Soroca, Republica Moldova”

Mod	Nºsec	Planşa	Nºdoc	Semnat	Data
ISP		Calitin			01.20
Geolog		Serepera			01.20
Verificat		Calitin			01.20
Elaborat		Maier			01.20

Inv. Nº _____
 Semnatura și data _____
 Schimb inv. Nº _____

Road plan Sc. 1:500 PC0+00-PC3+60/
 Plan traseu Sc. 1:500 PC0+00-PC3+60

Faza PE
 Planşa 2

CAD Geotehnical
 EXPERT
 mun. Chişinău

Linia de racordare cu plansa Nr.2 la PC 3+60
Match line with sheet Nr.2 on PC3+60

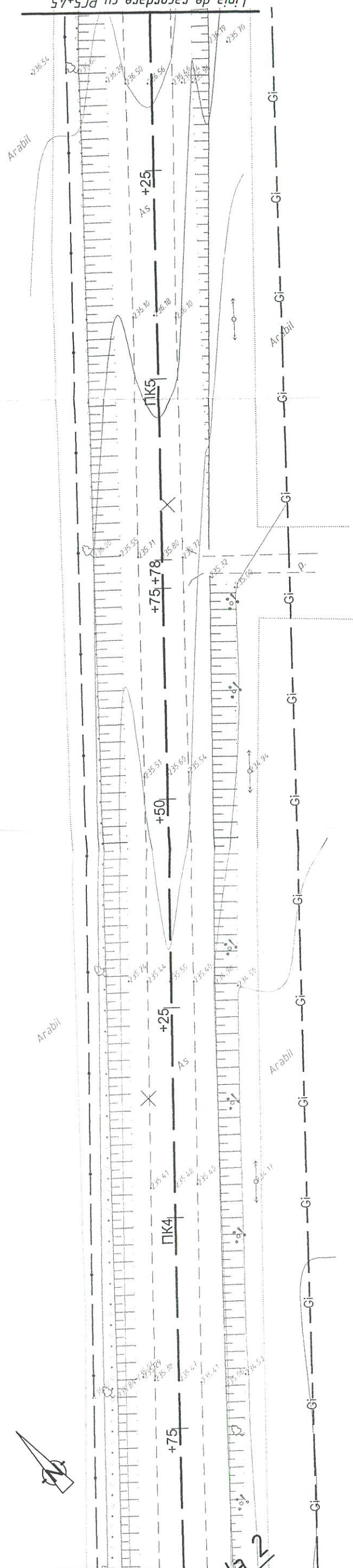

Linia de racordare cu PC5+45
Match line with PC5+45

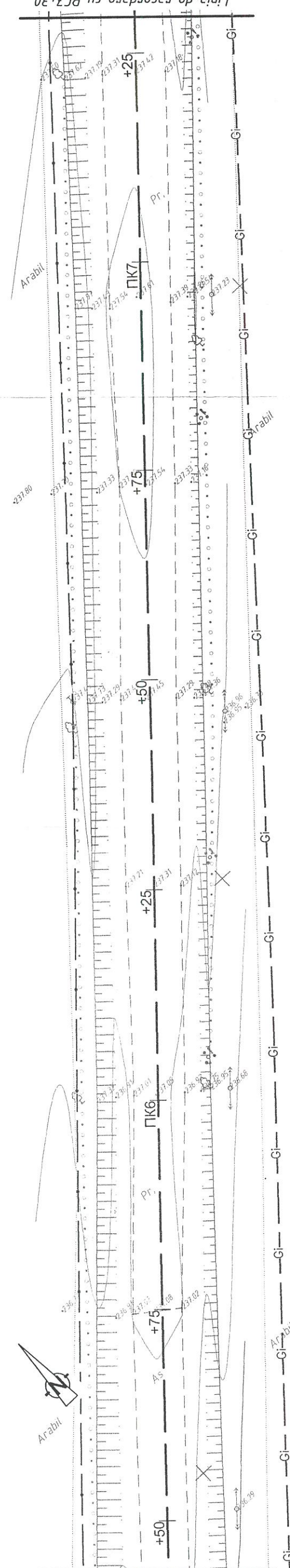

Linia de racordare cu PC7+30
Match line with PC7+30

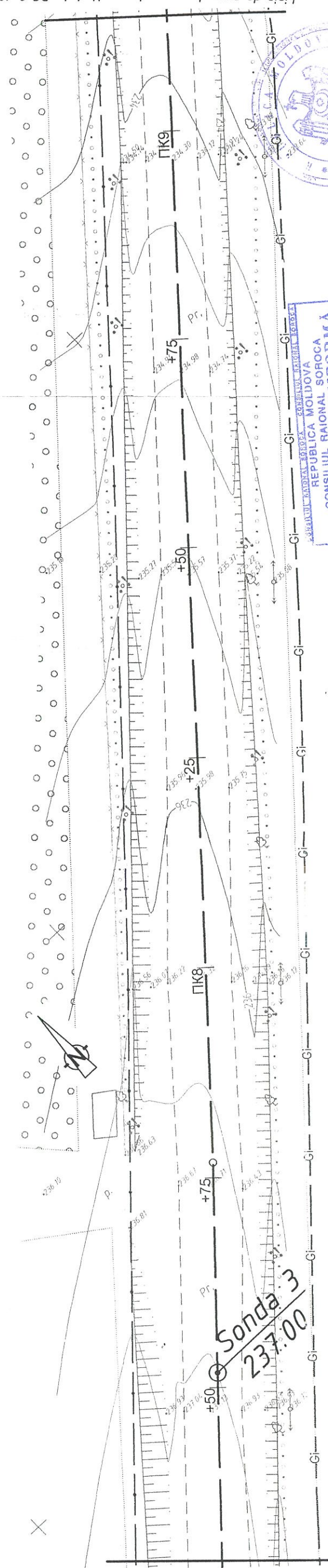

Sonda 3
237.00

Legenda
 ○ Sonda de foraj, nr.
 237.00
 — Cota gurii

CONSILIUL RAIONAL SOROCA
 COPIA ESTE CONFORMA
 ORIGINALULUI
 secretar al Consiliului Raional Soroca

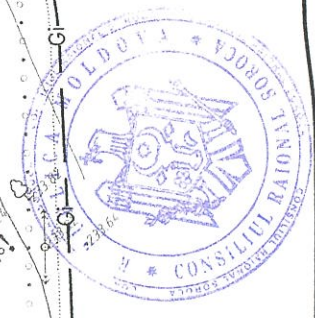

114-DA
 Road plan Sc. 1:500 PC3+60-PC9+10/
 Plan traseu Sc. 1:500 PC3+60-PC9+10

Mod.	Nfsec	Plansa	N°doc.	Semnat	Data

Linia de racordare cu plansa Nr.3 la PC 9+10
Match line with sheet Nr.3 on PC9+10

Linia de racordare cu PC11+00
Match line with PC11+00

Linia de racordare cu PC12+90
Match line with PC12+90

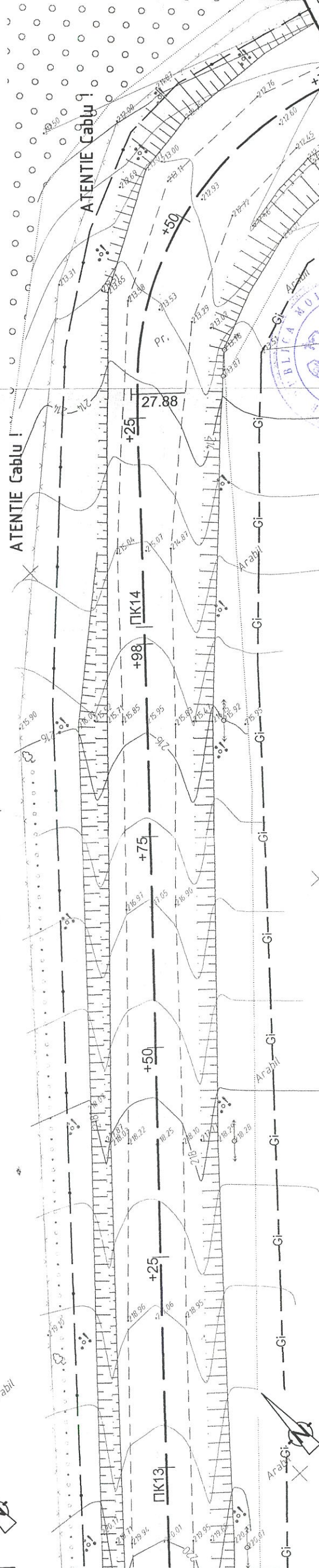
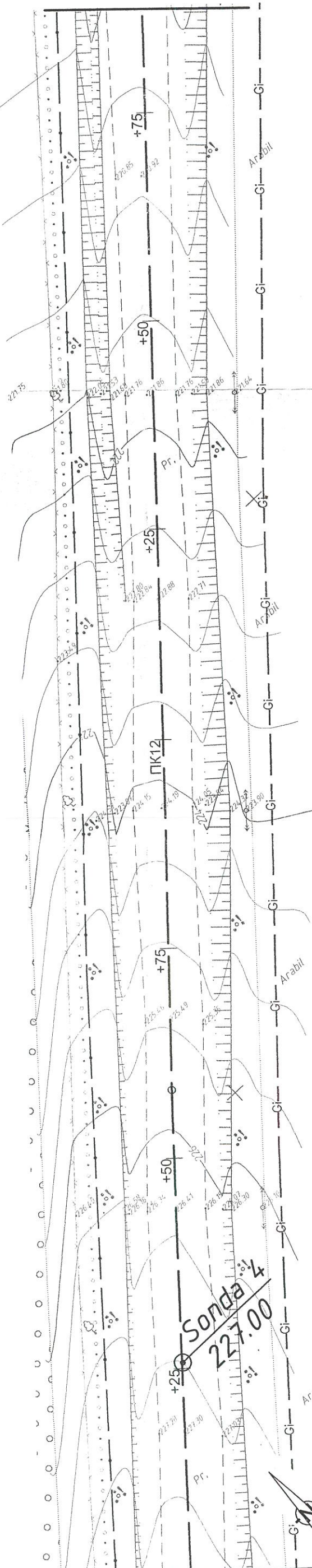
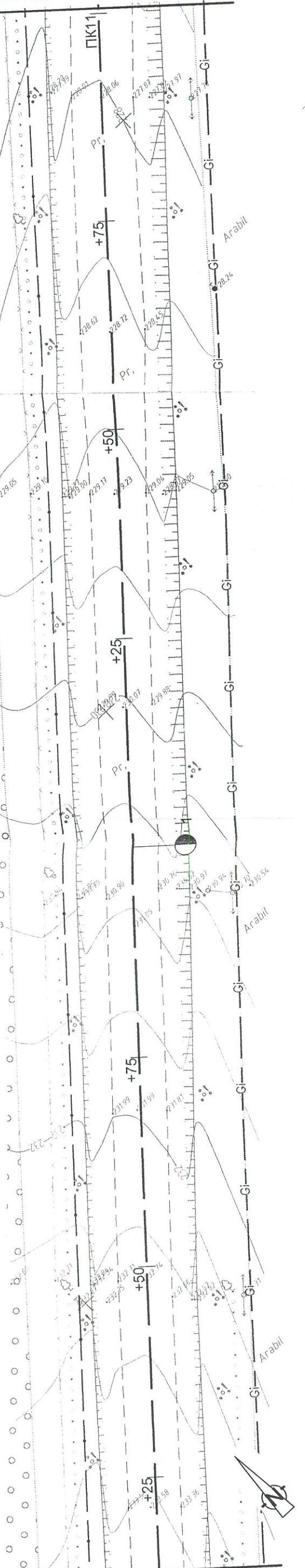

SECRETARIA RAIONALĂ DE PROIECTARE
REPUBLICA MOLDOVA
CONSILIUL RAIONAL SOROCA
**COPIA ESTE CONFORMA
CU ORIGINALUL**
secretar al Consiliului Raional Soroca

Legenda

© Son.4
227.00
Sonda de foraj, nr.
Cota gurii

Inv. Nr.

Semnatura si data

Schimb inv. Nr.

Mod. №sec Plansa N°doc. Semnat Data

114-DA
Road plan Sc. 1:500 PC9+10-PC14+75/
Plan traseu Sc. 1:500 PC9+10-PC14+75

Plansa
4



Legenda
 Sonda de foraj nr. 5
 Cota gurii 212.03

REPUBLICA MOLDOVA
 CONSILIUL RAIONAL SOROCA
 COPIA ESTE CONFORMA
 CU ORIGINALUL
 secretar al Consiliului Raional Soroca

Linia de racordare cu planşa Nr.6 la PC 20+25
 Match line with sheet Nr.6 on PC20+25

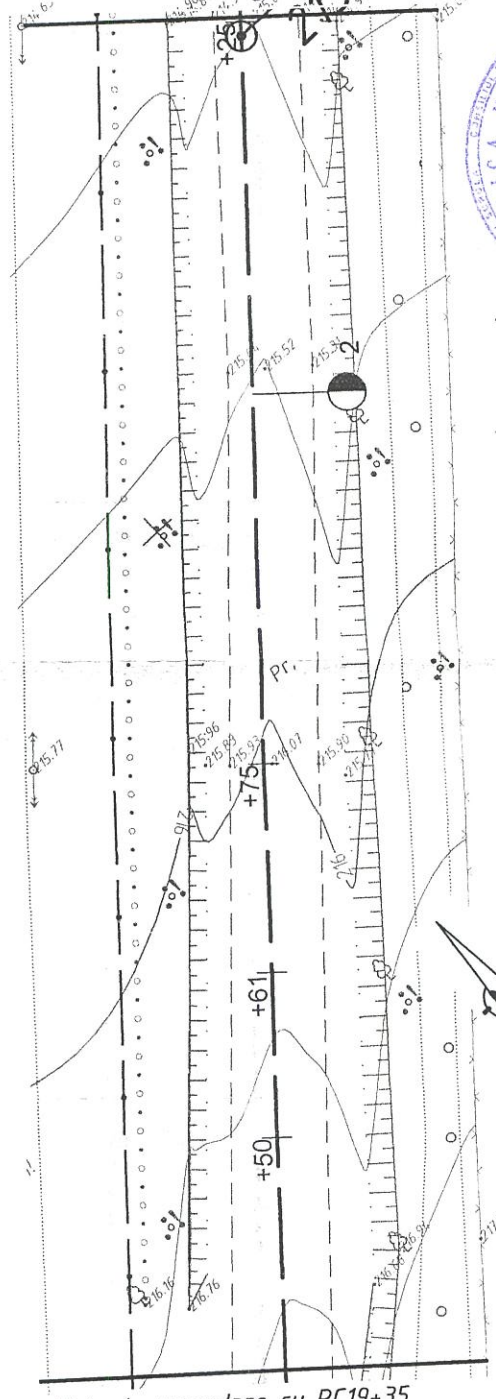

Linia de racordare cu PC19+35
 Match line with PC1+75

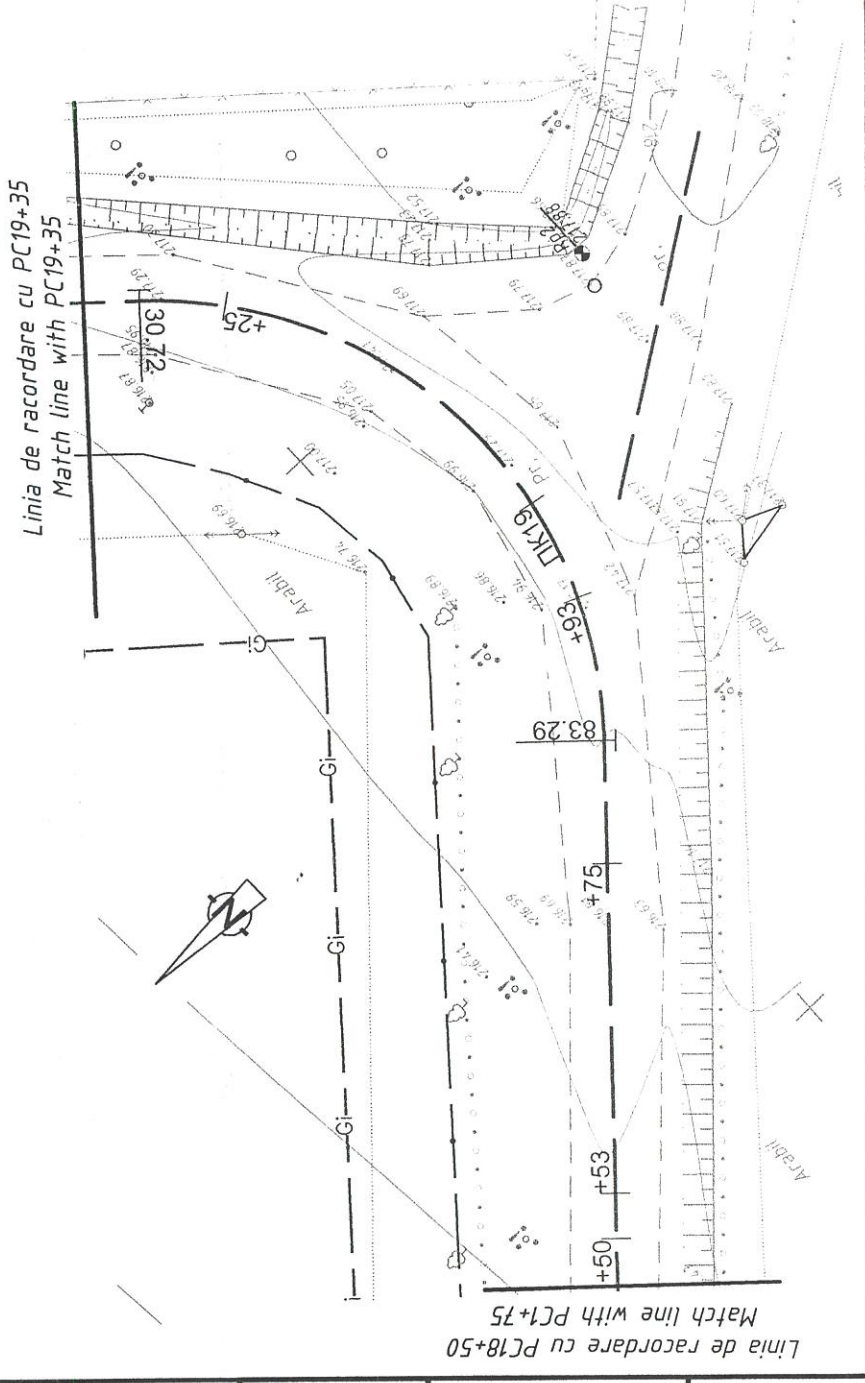

Linia de racordare cu PC19+35
 Match line with PC19+35

Linia de racordare cu PC18+50
 Match line with PC18+50

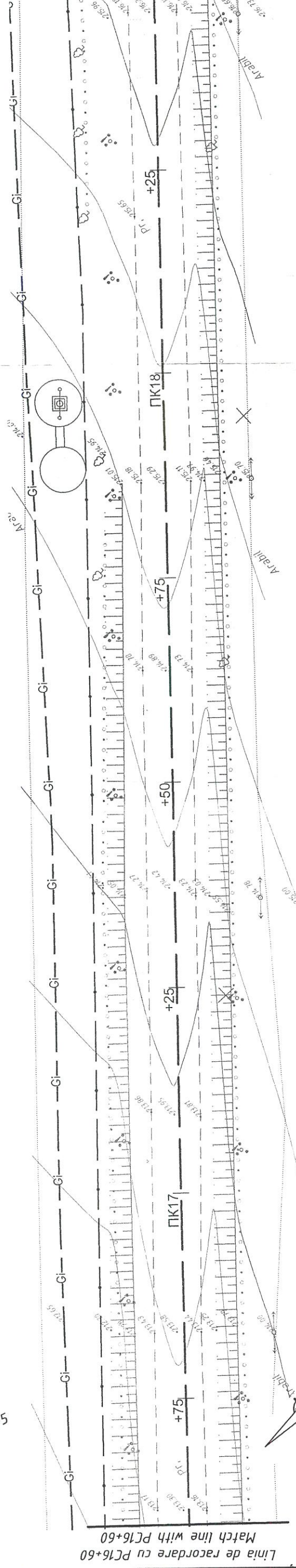

Linia de racordare cu PC16+60
 Match line with PC16+60

Linia de racordare cu PC16+60
 Match line with PC16+60

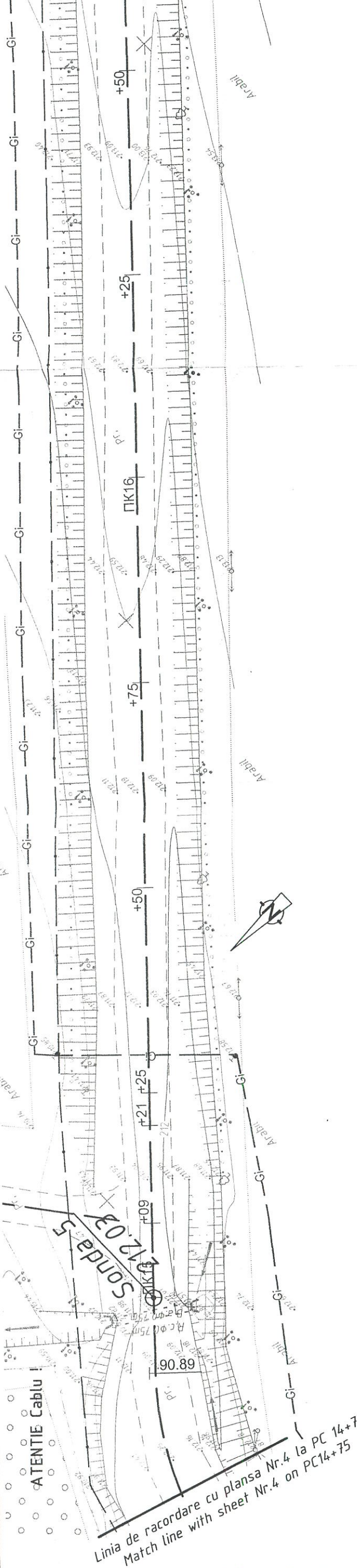

Linia de racordare cu planşa Nr.4 la PC 14+75
 Match line with sheet Nr.4 on PC14+75

ATENŢIE Cablu!

Sonda 5
 212.03

Linia de racordare cu plansa Nr.5 la PC 20+25
Match line with sheet Nr.5 on PC20+25

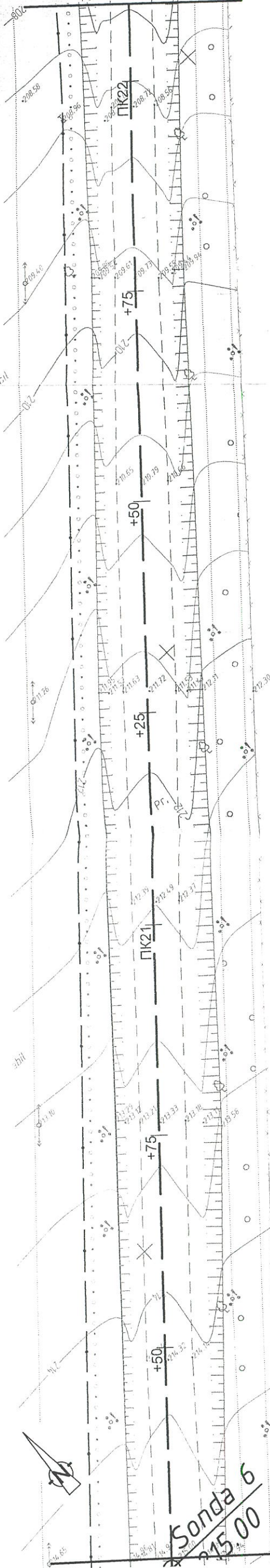

Sonda 6
115.00

Linia de racordare cu PC22+10
Match line with PC22+10

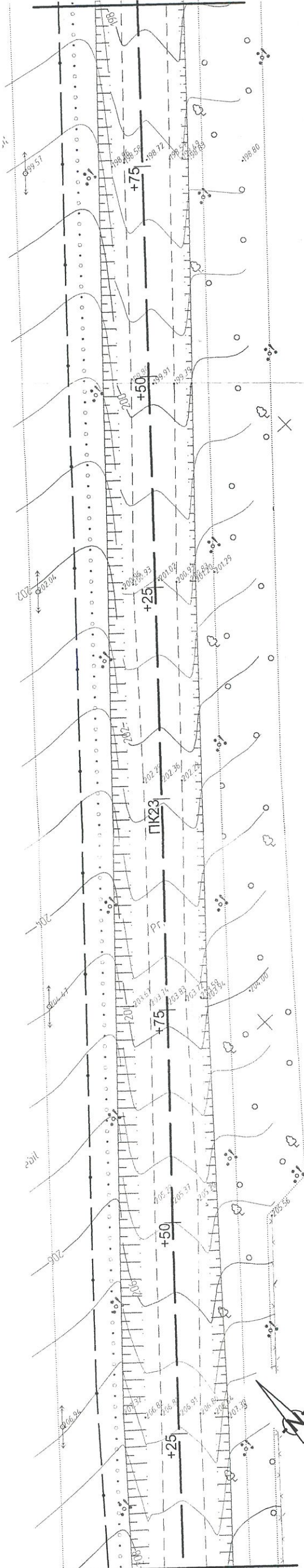

Sonda 7
192.00

Linia de racordare cu PC23+95
Match line with PC23+95

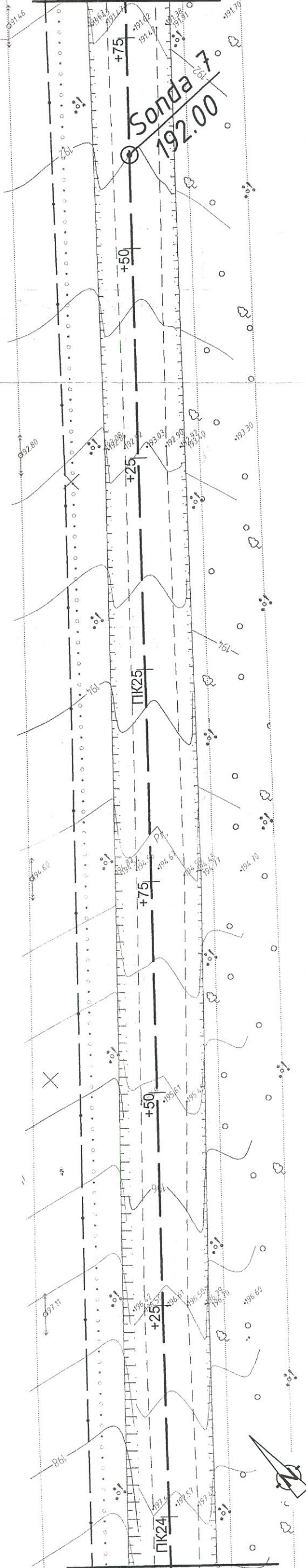

Legenda

○ Son. 7
192.00

— Sonda de foraj, nr.

— Cota gurii



SECRETARIATUL RAJONAL SOCOCA
REPUBLICA MOLDOVA
CONSILIUL RAJONAL SOCOCA
COPIA ESTE CONFORMA
CU ORIGINALUL
secretar al Consiliului Raional Soroca

Inv. Nr.

semnatura si data

himb inv. Nr.

Mod.

N°sec

Plansa N°doc.

Semnat

Data

114-DA

Road plan Sc. 1:500 PC20+25-PC25+80/

Plan traseu Sc. 1:500 PC20+25-PC25+80

Plansa

6

Linia de racordare cu plansa Nr.6 la PC 25+80
Match line with sheet Nr.6 on PC25+80

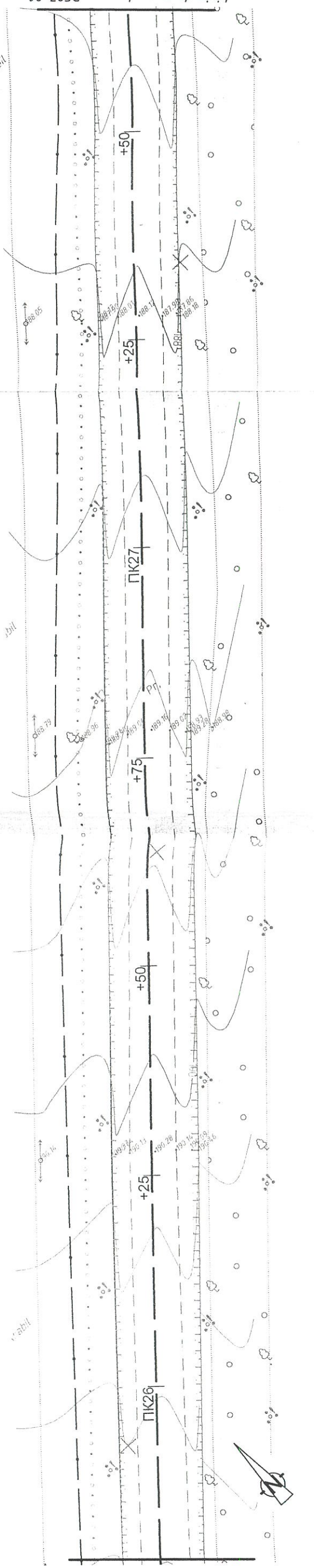

Linia de racordare cu PC27+90
Match line with PC27+90

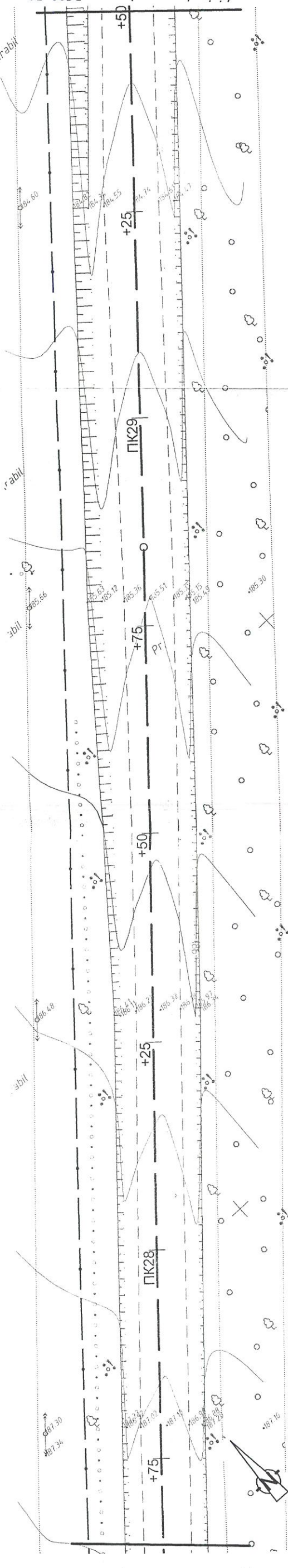

Linia de racordare cu PC29+50
Match line with PC29+50

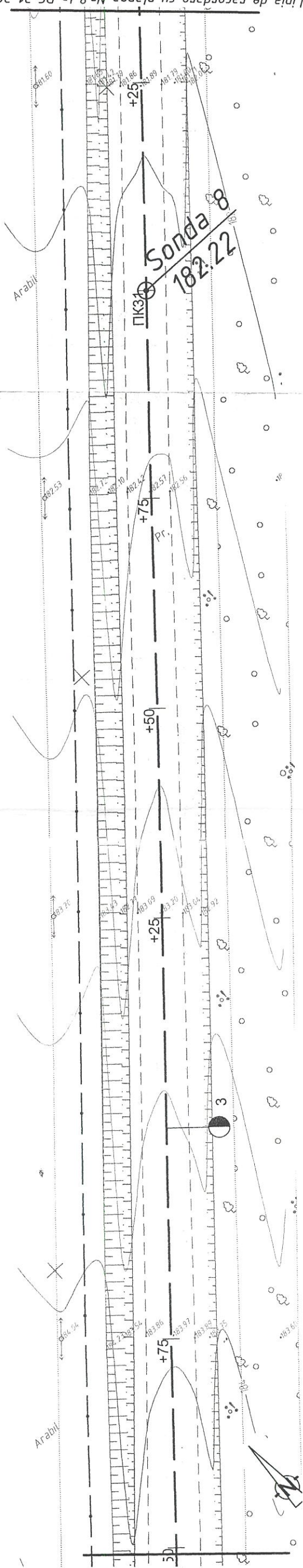

Legenda

- Son.8
182.22
- Sonda de foraj, nr.
- Cota garii

CONSILIUL RAIONAL SOROCA
REPUBLICA MOLDOVA
COPIA ESTE CONFORMA
CU ORIGINALUL
secretar al Consiliului Raional Soroca



Linia de racordare cu plansa Nr.8 la PC 31+30
Match line with sheet Nr.8 on PC31+30

Linia de racordare cu PC27+90
Match line with PC27+90

Iny. N°

Semnatura si data

Simb iny. N°

Mod.	N°sec	Plansa	N°doc.	Semnat	Data
					01.20

114-DA
Road plan Sc. 1:500 PC25+80-PC31+30/
Plan traseu Sc. 1:500 PC25+80-PC31+30

Plansa

7

Linia de racordare cu planşa Nr.7 la PC 31+30
Match line with sheet Nr.7 on PC31+30

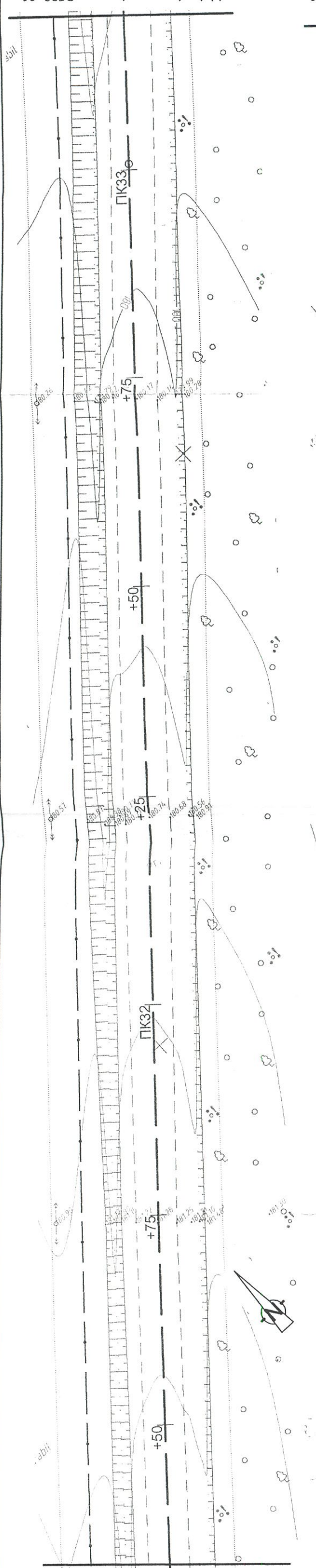

Linia de racordare cu PC33+20
Match line with PC33+20

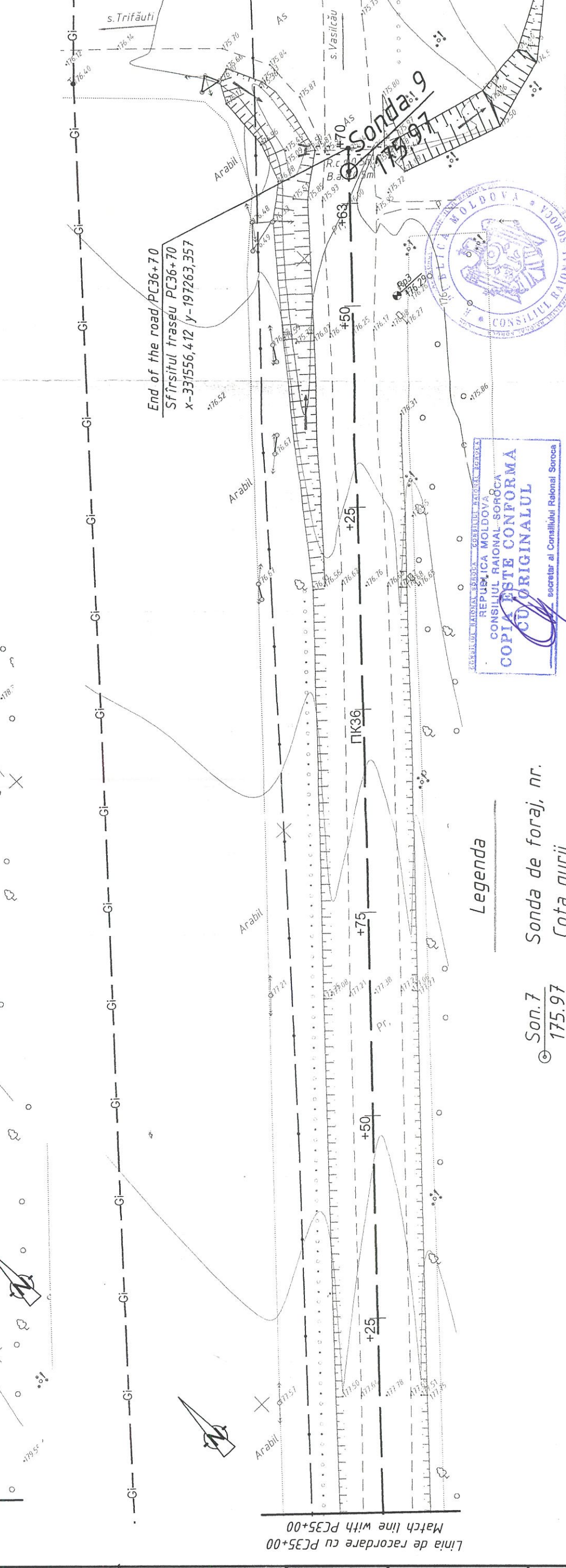
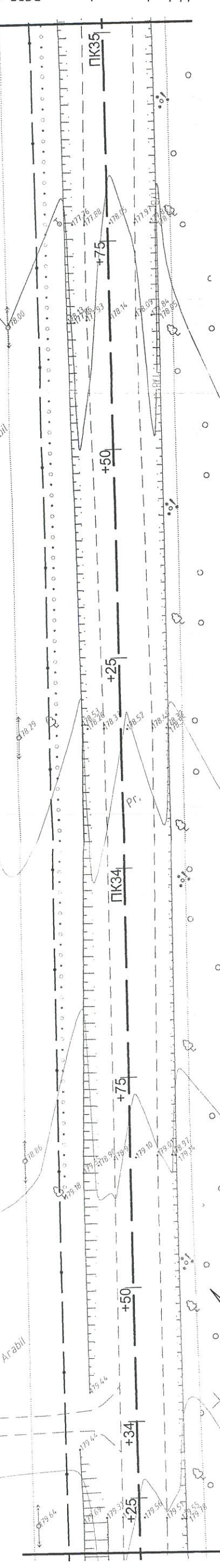

End of the road/PC36+70
Sfîrşitul traseu PC36+70
x-331556,412 y-197263,357

Legenda

- ⊙ Son.7 Sonda de foraj, nr. 175.97
- Cota gurii

REPUBLICA MOLDOVA
CONSILIUL RAIONAL SOROCA
COPIA ESTE CONFORMA
CU ORIGINALUL
Secretar al Consiliului Raional Soroca



Mod.	Nºsec	Planşa	Nº doc.	Semnat	Data
		114-DA			01.20

Road plan Sc. 1:500 PC31+30-PC36+70/
Plan traseu Sc. 1:500 PC31+30-PC36+70

Mod	Nr. sec	Planșa	Nr. doc	Semnat	Data
					01.20
					01.20
					01.20
					01.20
					01.20
					01.20

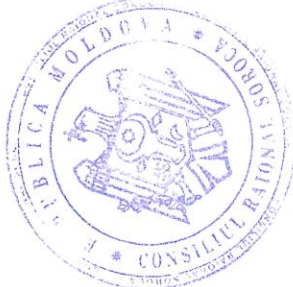

REPUBLICA MOLDOVA
 CONSILIUL RAIONAL SOROCA
COPIA ESTE CONFORMA
CU ORIGINALUL
 Secretar al Consiliului Raional Soroca

114-DA

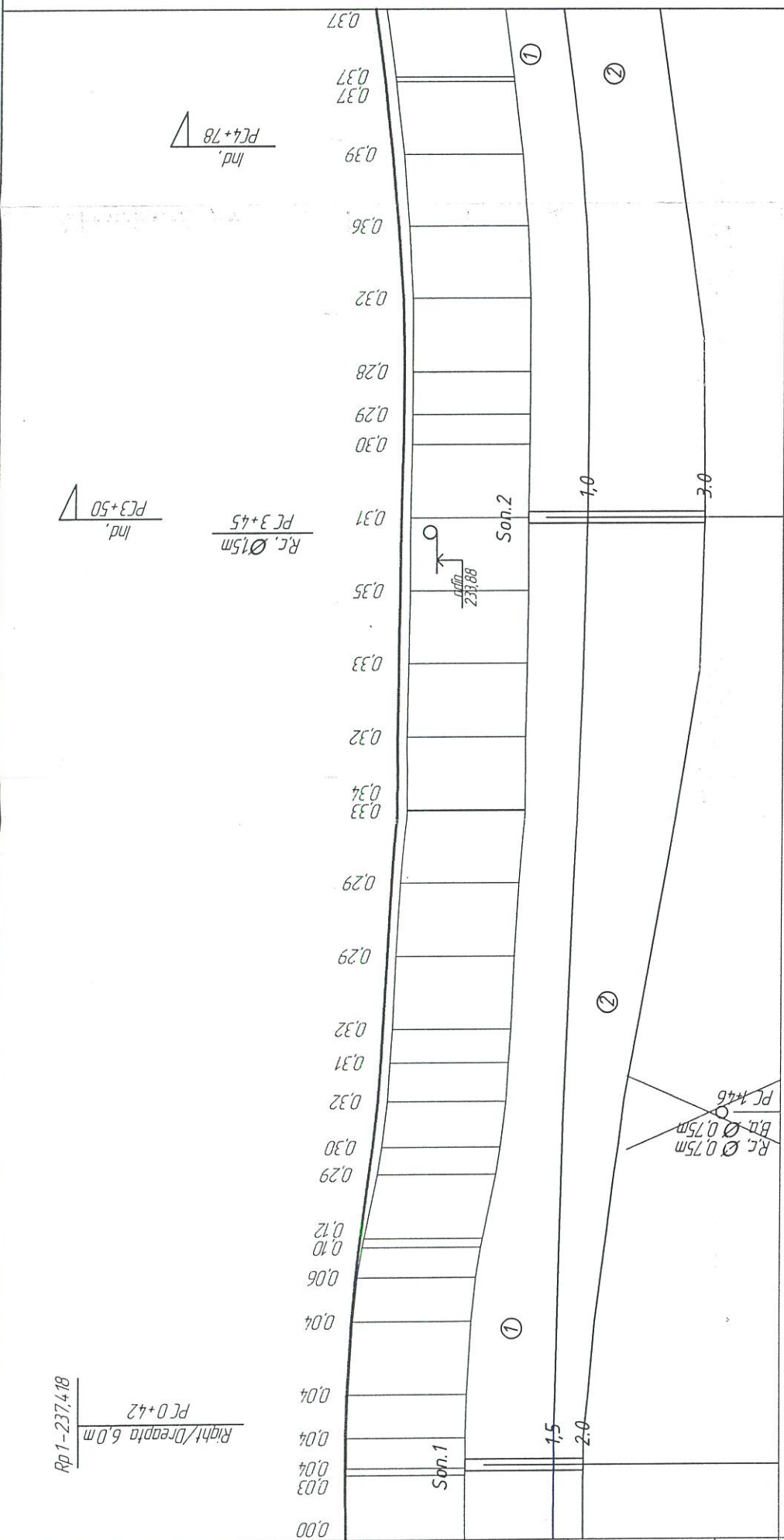

Stationing	Type 1 Elevation	Type 2 Elevation
237.52	237.52	237.52
237.50	237.50	237.50
237.49	237.49	237.49
237.45	237.45	237.45
237.34	237.34	237.34
237.21	237.21	237.21
237.09	237.09	237.09
237.05	237.05	237.05
236.99	236.99	236.99
236.93	236.93	236.93
236.86	236.86	236.86
236.78	236.78	236.78
236.66	236.66	236.66
236.49	236.49	236.49
236.40	236.40	236.40
236.33	236.33	236.33
236.20	236.20	236.20
235.91	235.91	235.91
235.77	235.77	235.77
235.70	235.70	235.70
235.58	235.58	235.58
235.50	235.50	235.50
235.49	235.49	235.49
235.47	235.47	235.47
235.48	235.48	235.48
235.47	235.47	235.47
235.48	235.48	235.48
235.49	235.49	235.49
235.59	235.59	235.59
235.76	235.76	235.76
235.81	235.81	235.81
235.95	235.95	235.95
236.07	236.07	236.07
236.46	236.46	236.46
236.78	236.78	236.78

Legenda

1 Rambu de sol: beton asfaltic piatra sparta argila nisipoase p.33v EGC-I
 2 Argila nisipoase, profoase, p.33v. EGC-II

Stareea solului
 Составные грунтов

Argila nisipoase, argila
 solid
 semisolid

Sc 1:2000 - pe orizontala
 Sc 1:200 - pe verticala
 Sc 1:100 - sol

Tip profilului dupa umiditate / Profile type after humidity

Tip profilului transversal / Typical Cross-section	Type 1	Type 2
Sant sting / Open channel left	25, 50, 75	45, 50, 75
Sant drept / Open channel right	25, 50, 75	45, 50, 75

Consolidare / Consolidation

Declivitate / Gradient, %	20	12
Lungimea / Distance, m	50	105

Cota fundului, m / Elevation, m

237.17	236.97	236.68	236.40	236.23	236.10	235.80	235.53	235.43	235.33	235.20	235.08	234.96	234.83	234.71	234.60	234.63	234.76	234.88	235.00	235.14	235.41	235.68	235.99
--------	--------	--------	--------	--------	--------	--------	--------	--------	--------	--------	--------	--------	--------	--------	--------	--------	--------	--------	--------	--------	--------	--------	--------

Consolidare / Consolidation

Declivitate / Gradient, %	13	96	85	95	85	13
Lungimea / Distance, m	23	50	136	50	136	50

Cota fundului, m / Elevation, m

237.52	237.50	237.49	237.45	237.30	237.15	237.09	237.05	236.93	236.78	236.66	236.49	236.40	236.33	236.20	235.91	235.77	235.70	235.58	235.50	235.49	235.47	235.48	235.78	235.81	235.95	236.07	236.46	236.78
--------	--------	--------	--------	--------	--------	--------	--------	--------	--------	--------	--------	--------	--------	--------	--------	--------	--------	--------	--------	--------	--------	--------	--------	--------	--------	--------	--------	--------

Cota axei, m / Finished carriageway level, m

237.52	237.50	237.49	237.45	237.30	237.15	237.09	237.05	236.93	236.78	236.66	236.49	236.40	236.33	236.20	235.91	235.77	235.70	235.58	235.50	235.49	235.47	235.48	235.78	235.81	235.95	236.07	236.46	236.78
--------	--------	--------	--------	--------	--------	--------	--------	--------	--------	--------	--------	--------	--------	--------	--------	--------	--------	--------	--------	--------	--------	--------	--------	--------	--------	--------	--------	--------

Cota teren, m / Ground level, m

237.51	237.49	237.45	237.30	237.15	237.09	237.05	236.93	236.78	236.66	236.49	236.40	236.33	236.20	235.91	235.77	235.70	235.58	235.50	235.49	235.47	235.48	235.78	235.81	235.95	236.07	236.46	236.78
--------	--------	--------	--------	--------	--------	--------	--------	--------	--------	--------	--------	--------	--------	--------	--------	--------	--------	--------	--------	--------	--------	--------	--------	--------	--------	--------	--------

Distanta, m / Distance, m

23	7	10	15	25	15	10	3	22	9	16	13	12	25	25	25	25	25	25	25	25	25	25	25	25	25	25	25	25
----	---	----	----	----	----	----	---	----	---	----	----	----	----	----	----	----	----	----	----	----	----	----	----	----	----	----	----	----

Pictet / Survey station
 Elemente plan / Plan elements
 Kilometri / Kilometers

0	L-35	55	11-27.12-27	90	1	2	3	4	5	L-687
---	------	----	-------------	----	---	---	---	---	---	-------

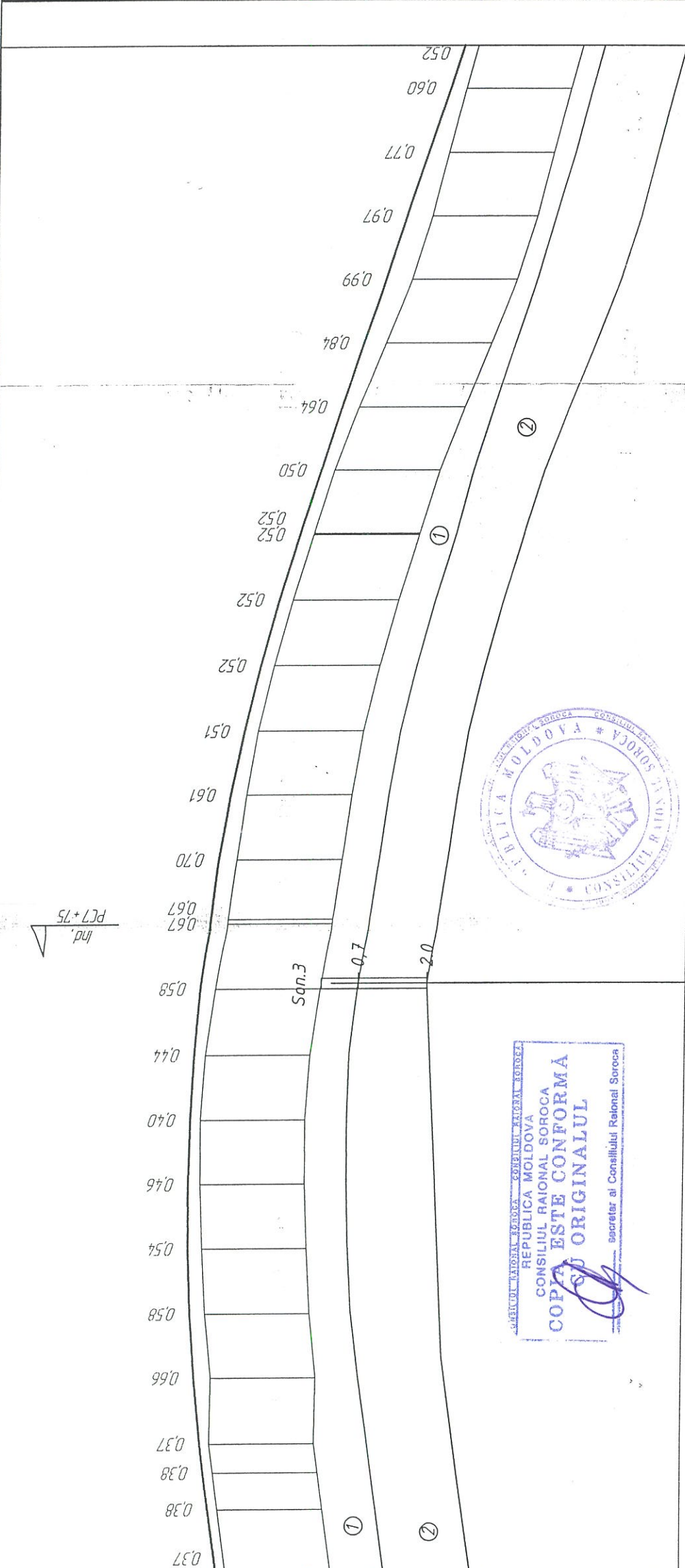

Legenda

① Rambleu de sol: beton asfaltic piatra sparta argila nisipoase p.33v EGC240
 Argila nisipoase, profoase, p.33v. EGC-II

② Starea solului
 Составные грунтов

Argila nisipoase, argila
solid
semisolid

Sc 1:2000 - pe orizontala
 Sc 1:200 - pe verticala
 Sc 1:100 - sol

Tip profilului dupa umeditate / Profile type after humidity	Type 1		Type 3	
Tip profilului transversal / Typical Cross-section	Type 1		Type 3	
Sant sifing Open channel left	Declivitate, % Gradient, %	12	12	12
	Lungimea, m Distance, m	50	50	50
Sant drept Open channel right	Declivitate, % Gradient, %	5	5	5
	Lungimea, m Distance, m	50	50	50
Cota fundului, m Elevation, m	235.99	236.30	236.32	236.62
	236.55	236.82	236.94	237.06
Cota fundului, m Elevation, m	237.07	237.19	237.32	237.44
	237.74	237.86	238.00	238.12
Cota fundului, m Elevation, m	238.83	238.95	239.07	239.19
	239.70	239.82	239.94	240.06
Declivitate, % Gradient, %	71	71	71	71
	40	40	40	40
Cota axei, m / Finished carriageway level, m	237.11	237.30	237.43	237.56
	237.78	237.92	238.05	238.18
Cota teren, m / Ground level, m	236.41	236.73	237.03	237.33
	237.06	237.36	237.66	237.96
Distanța, m / Distance, m	25	14	11	25
	25	25	25	25
Punct / Survey station Elemente plan / Plan elements Kilometri / Kilometers	6	7	8	9
	10	11	12	13

Mod, N°sec	Plansă N°doc	Semnat	Data
			01.20



REPUBLICA MOLDOVA
CONSILIUL RAIONAL SOROCA
CONSISTENȚE CONFORMA
COPILUL ORIGINALUL
Secretariat al Consiliului Raional Soroca

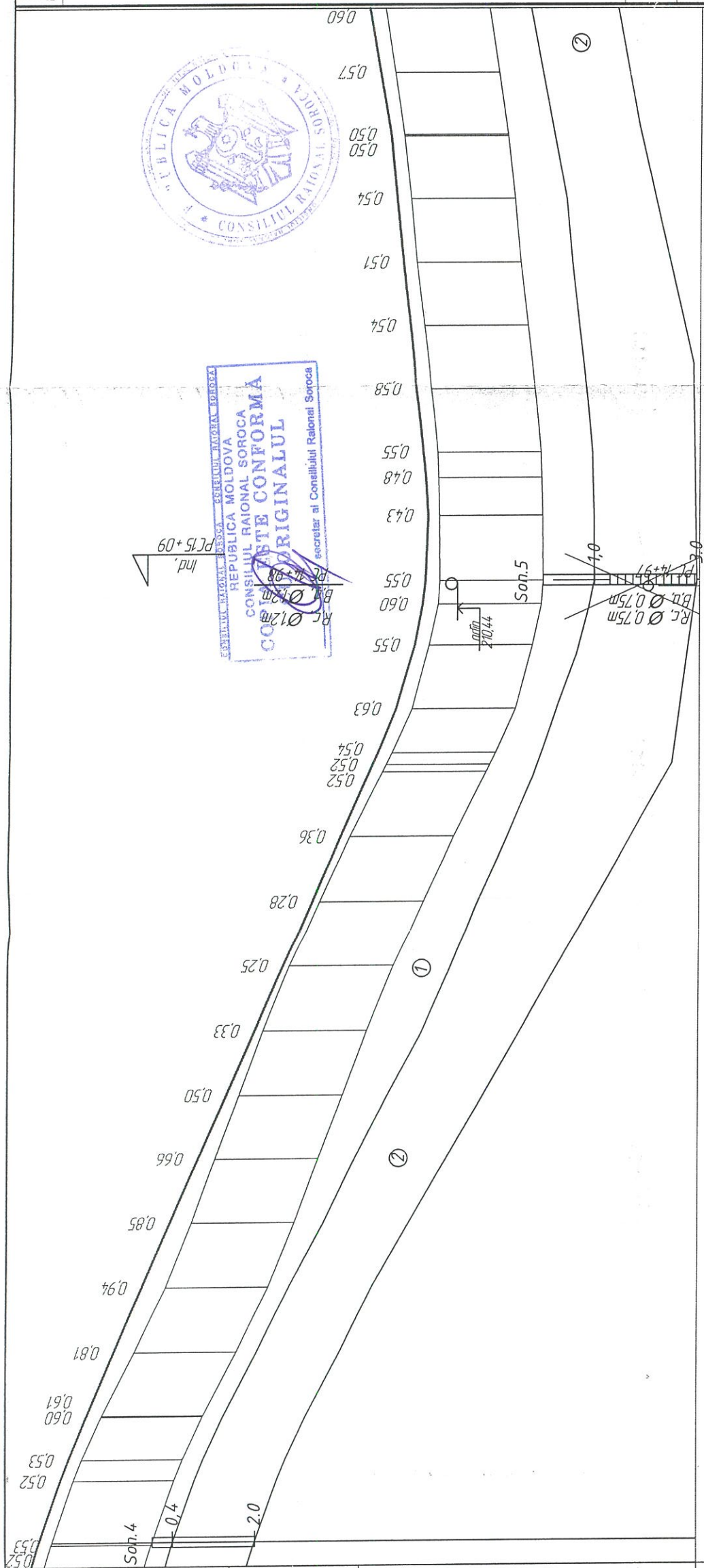

Legenda

- ① Rambu de sol: beton asfaltic piatra sparta argila nisipoase p.33v EGC-I
- ② Argila nisipoase, profoase, p.33v. EGC-II

Starea solului
Состояние грунта

Argila nisipoase, argila
solid
semisolid

Sc 1:2000 - pe orizontala
Sc 1:200 - pe verticala
Sc 1:100 - sol

Tip profilului dupa umeditate / Profile type after humidity

Tip profilului transversal / Typical Cross-section

Consolidare / Consolidation

Declivitate % / Gradient, %

Lungimea, m / Distance, m

Cota fundului, m / Elevation, m

Consolidare / Consolidation

Declivitate % / Gradient, %

Lungimea, m / Distance, m

Cota fundului, m / Elevation, m

Declivitate, % curbă, m / Gradient, % vertical radius, m

Cota axei, m / Finished carriageway level, m

Cota teren, m / Ground level, m

Distanța, m / Distance, m

Pichet / Survey station

Elemente plan / Plan elements

Kilometri / Kilometers

Station	Type 1 (m)	Type 3 (m)	Distance (m)	Elevation (m)	Distance (m)	Elevation (m)	Distance (m)	Elevation (m)	Distance (m)	Elevation (m)	Station
225	226.66	226.66	34	225.86	50	225.45	75	224.51	30	225.62	226.38
224	224.60	224.60	50	225.86	50	225.45	75	224.51	30	225.62	226.38
223	223.33	223.33	25	225.86	50	225.45	75	224.51	30	225.62	226.38
222	222.08	222.08	25	225.86	50	225.45	75	224.51	30	225.62	226.38
221	221.09	221.09	100	225.86	50	225.45	75	224.51	30	225.62	226.38
220	220.09	220.09	25	225.86	50	225.45	75	224.51	30	225.62	226.38
219	219.10	219.10	25	225.86	50	225.45	75	224.51	30	225.62	226.38
218	218.76	218.76	25	225.86	50	225.45	75	224.51	30	225.62	226.38
217	217.75	217.75	25	225.86	50	225.45	75	224.51	30	225.62	226.38
216	216.63	216.63	25	225.86	50	225.45	75	224.51	30	225.62	226.38
215	215.82	215.82	25	225.86	50	225.45	75	224.51	30	225.62	226.38
214	214.21	214.21	25	225.86	50	225.45	75	224.51	30	225.62	226.38
213	213.85	213.85	35	225.86	50	225.45	75	224.51	30	225.62	226.38
212	212.70	212.70	25	225.86	50	225.45	75	224.51	30	225.62	226.38
211	212.44	212.44	25	225.86	50	225.45	75	224.51	30	225.62	226.38
210	212.10	212.10	16	225.86	50	225.45	75	224.51	30	225.62	226.38
209	212.04	212.04	9	225.86	50	225.45	75	224.51	30	225.62	226.38
208	212.10	212.10	25	225.86	50	225.45	75	224.51	30	225.62	226.38
207	212.44	212.44	25	225.86	50	225.45	75	224.51	30	225.62	226.38
206	212.06	212.06	25	225.86	50	225.45	75	224.51	30	225.62	226.38
205	212.11	212.11	10	225.86	50	225.45	75	224.51	30	225.62	226.38
204	212.14	212.14	25	225.86	50	225.45	75	224.51	30	225.62	226.38
203	212.36	212.36	25	225.86	50	225.45	75	224.51	30	225.62	226.38
202	212.65	212.65	25	225.86	50	225.45	75	224.51	30	225.62	226.38
201	212.93	212.93	25	225.86	50	225.45	75	224.51	30	225.62	226.38
200	213.15	213.15	25	225.86	50	225.45	75	224.51	30	225.62	226.38
199	213.44	213.44	25	225.86	50	225.45	75	224.51	30	225.62	226.38
198	213.79	213.79	25	225.86	50	225.45	75	224.51	30	225.62	226.38
197	214.18	214.18	25	225.86	50	225.45	75	224.51	30	225.62	226.38

Terrain data

Date proiect

K-63
T1-40 T2-40
R-40 Y-90°50'

L-270
A-47°34'42"

L-392

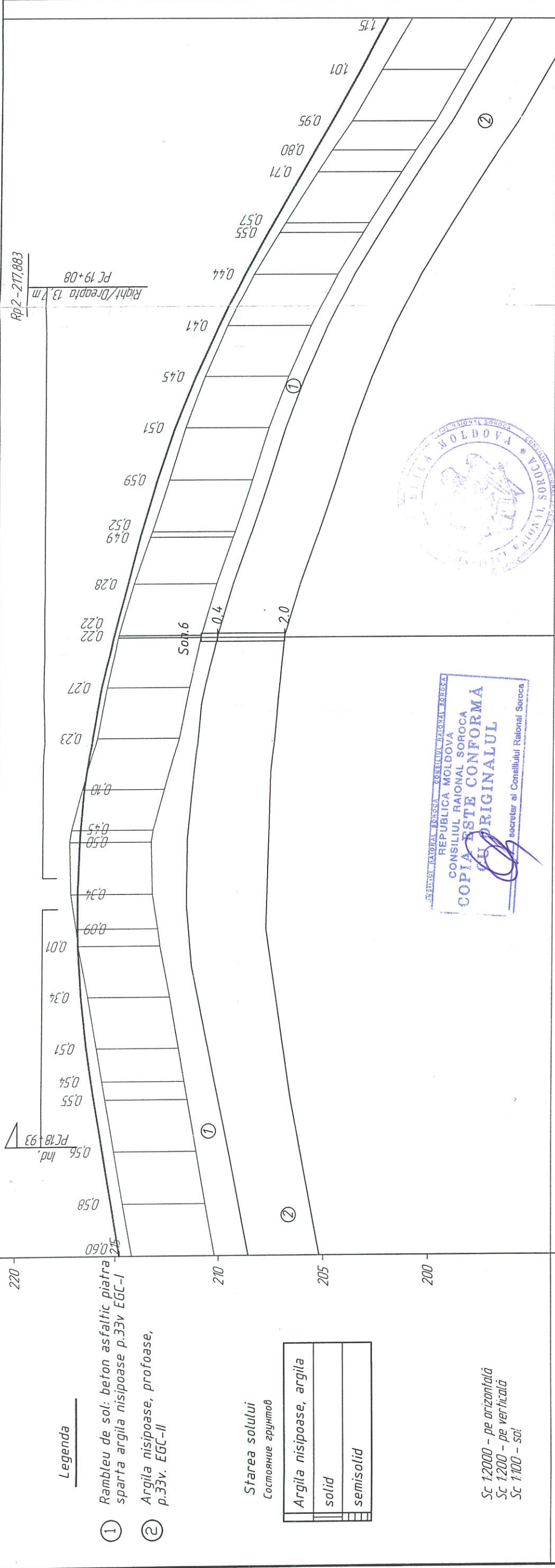

Legenda

- ① Rambieu de sol: beton asfaltic piatra sparta argila nisipoase p.33v EGC-I
- ② Argila nisipoase, profoase, p.33v, EGC-II

Starea solului
 Составные грунтов

Argila nisipoase, argila
solid
semisolid

Sc 1:2000 - pe orizontala
 Sc 1:200 - pe verticala
 Sc 1:100 - sol

Tip profilului dupa umeditate / Profile type after humidity		Type 1		Type 1		Type 3	
Tip profilului transversal / Typical Cross-section		Type 1		Type 1		Type 3	
Sant si sting Open channel left		Sant drept Open channel right		Sant drept Open channel right		Sant drept Open channel right	
Consolidare / Consolidation	Declivitate, % Gradient, %	Consolidare / Consolidation	Declivitate, % Gradient, %	Consolidare / Consolidation	Declivitate, % Gradient, %	Consolidare / Consolidation	Declivitate, % Gradient, %
Lungimea, m Distance, m		Lungimea, m Distance, m		Lungimea, m Distance, m		Lungimea, m Distance, m	
Cota fundului, m Elevation, m		Cota fundului, m Elevation, m		Cota fundului, m Elevation, m		Cota fundului, m Elevation, m	
Cota teren, m / Ground level, m		Cota teren, m / Ground level, m		Cota teren, m / Ground level, m		Cota teren, m / Ground level, m	
Distanța, m / Distance, m		Distanța, m / Distance, m		Distanța, m / Distance, m		Distanța, m / Distance, m	
Pictel / Survey station		Pictel / Survey station		Pictel / Survey station		Pictel / Survey station	
Elemente plan / Plan elements		Elemente plan / Plan elements		Elemente plan / Plan elements		Elemente plan / Plan elements	
Kilometri / Kilometers		Kilometri / Kilometers		Kilometri / Kilometers		Kilometri / Kilometers	
214.78	215.07	214.78	215.07	214.78	215.07	214.78	215.07
215.50	216.05	215.50	216.05	215.50	216.05	215.50	216.05
216.63	216.21	216.63	216.21	216.63	216.21	216.63	216.21
217.00	216.45	217.00	216.45	217.00	216.45	217.00	216.45
217.26	216.73	217.26	216.73	217.26	216.73	217.26	216.73
217.33	216.89	217.33	216.89	217.33	216.89	217.33	216.89
217.24	217.00	217.24	217.00	217.24	217.00	217.24	217.00
216.71	216.91	216.71	216.91	216.71	216.91	216.71	216.91
216.03	216.88	216.03	216.88	216.03	216.88	216.03	216.88
215.52	216.73	215.52	216.73	215.52	216.73	215.52	216.73
214.98	216.21	214.98	216.21	214.98	216.21	214.98	216.21
214.26	215.20	214.26	215.20	214.26	215.20	214.26	215.20
213.47	214.54	213.47	214.54	213.47	214.54	213.47	214.54
213.37	213.96	213.37	213.96	213.37	213.96	213.37	213.96
212.56	213.04	212.56	213.04	212.56	213.04	212.56	213.04
211.78	212.34	211.78	212.34	211.78	212.34	211.78	212.34
210.86	211.39	210.86	211.39	210.86	211.39	210.86	211.39
209.79	210.42	209.79	210.42	209.79	210.42	209.79	210.42
208.53	209.44	208.53	209.44	208.53	209.44	208.53	209.44
207.32	208.12	207.32	208.12	207.32	208.12	207.32	208.12
206.81	207.77	206.81	207.77	206.81	207.77	206.81	207.77
205.40	206.77	205.40	206.77	205.40	206.77	205.40	206.77
204.83	205.40	204.83	205.40	204.83	205.40	204.83	205.40
203.88	204.83	203.88	204.83	203.88	204.83	203.88	204.83
202.47	203.88	202.47	203.88	202.47	203.88	202.47	203.88
201.04	202.47	201.04	202.47	201.04	202.47	201.04	202.47

R - 30.4 - 90°34'33"
 K - 47
 T1 - 30.12 - 30



REPUBLICA MOLDOVA
 CONSILIUL RAIONAL SOROCA
COPIA ESTE CONFORMA ORIGINALULUI
 secretar al Consiliului Raional Soroca

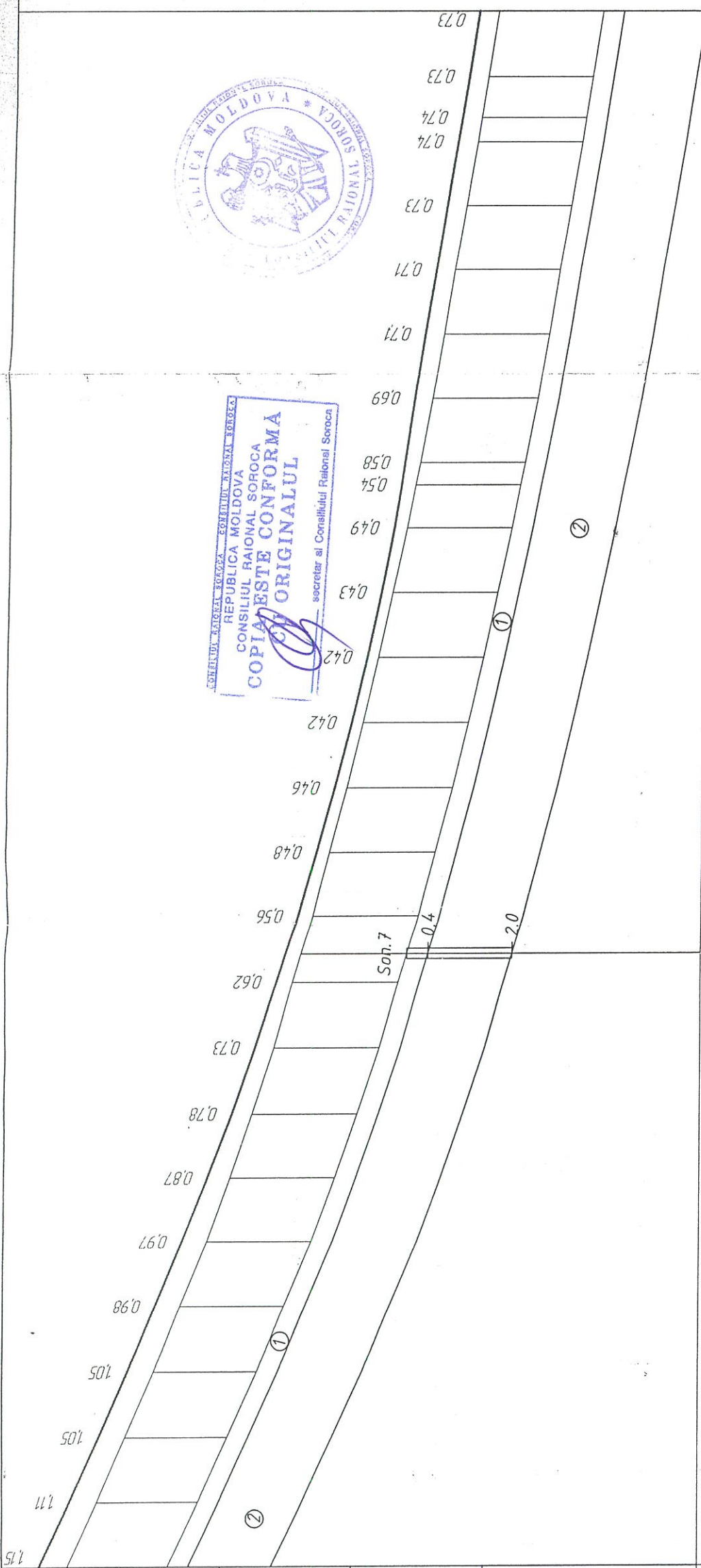

Legenda

- ① Rambleu de sol: beton asfaltic piatra sparta argila nisipoase p.33v EGC-I
- ② Argila nisipoase, profoase, p.33v. EGC-II

Starea solului
 Составные грунтов

Argila nisipoase, argila
solid
semisolid

Sc 1:2000 - pe orizontala
 Sc 1:200 - pe verticala
 Sc 1:100 - sol

Tip profilului dupa umeditate / Profile type after humidity

Tip profilului transversal / Typical Cross-section

Consolidare / Consolidation
 Declivitate, %
 Gradient, %
 Lungimea, m
 Distance, m

Cota fundului, m
 Elevation, m

Consolidare / Consolidation
 Declivitate, %
 Gradient, %
 Lungimea, m
 Distance, m

Cota fundului, m
 Elevation, m

Declivitate, %
 Gradient, %
 curba, m
 vertical radius, m

Cota axei, m / Finished carriageway level, m

Cota teren, m / Ground level, m

Distanța, m / Distance, m

Pictel / Survey station

Elemente plan / Plan elements

Kilometri / Kilometers

Tip profilului dupa umeditate / Profile type after humidity	Tip profilului transversal / Typical Cross-section	Consolidare / Consolidation Declivitate, % Gradient, % Lungimea, m Distance, m	Cota fundului, m Elevation, m	Consolidare / Consolidation Declivitate, % Gradient, % Lungimea, m Distance, m	Cota fundului, m Elevation, m	Declivitate, % Gradient, % curba, m vertical radius, m	Cota axei, m / Finished carriageway level, m	Cota teren, m / Ground level, m	Distanța, m / Distance, m	Pictel / Survey station	Elemente plan / Plan elements	Kilometri / Kilometers
Type 1	Type 3		20134		20101		202.19	201.04	25			
			19892		19860		199.77	198.72	25			
			19773		19741		198.64	197.59	25			
			19667		19644		197.56	196.58	25			
			19562		19545		196.53	195.56	25			
			19459		19447		195.55	194.68	25			
			19359		19370		194.63	193.85	25			
			19260		19291		193.76	193.03	25			
			19196		19213		192.94	192.32	25			
			19131		19136		192.17	191.61	25			
			19065		19061		191.45	190.97	25			
			18900		18999		190.79	190.33	25			
			18935		18935		189.75	189.75	25			
			18870		18874		189.61	189.19	25			
			18824		18830		189.11	188.68	25			
			18779		18784		188.65	188.16	25			
			18735		18740		188.24	187.84	9			
			18694		18695		187.85	187.16	25			
			18654		18648		187.45	186.74	25			
			18613		18604		187.06	186.35	25			
			18569		18559		186.66	185.93	25			
			18524		18518		186.26	185.52	25			
			18508		18504		186.12	185.38	9			
			18454		18479		185.87	185.14	25			
			18367		18440		185.47	184.74	25			

Date proiect

Terrain data

24

25

26

27

28

29

I - 954

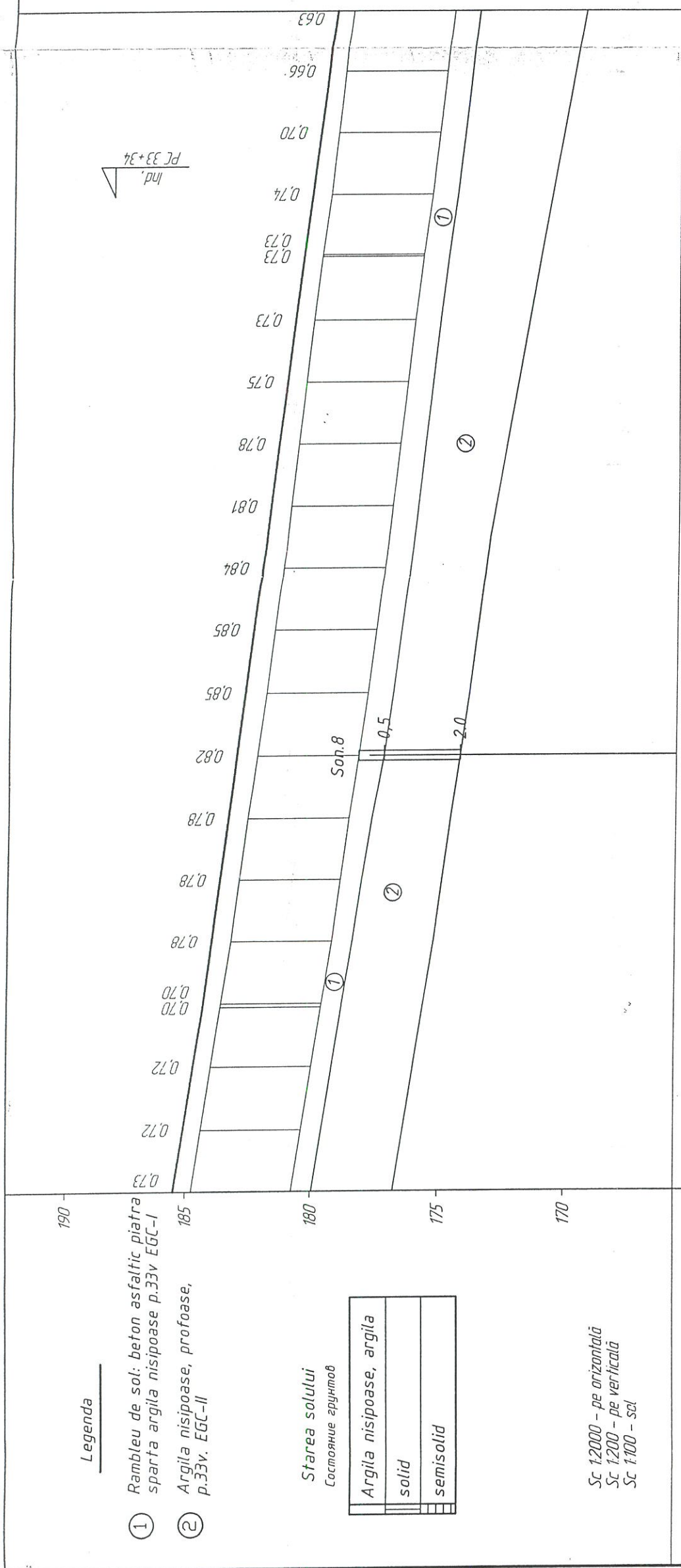

Legenda

- ① Rambuie de sol: beton asfaltic piatra sparta argila nisipoase p.33v EGC-I
- ② Argila nisipoase, profoase, p.33v. EGC-II

Starea solului
 Составные грунтов

Argila nisipoase, argila
solid
semisolid

Sc 1:2000 - pe orizontala
 Sc 1:200 - pe verticala
 Sc 1:100 - sol

Tip profilului dupa umeditate / Profile type after humidity		Type 1		Type 3		Type 3		Type 1		Type 3		Type 1		Type 3		Type 1		Type 3		Type 1		Type 3	
Tip profilului transversal / Typical Cross-section		Consolidare / Consolidation		Consolidare / Consolidation		Consolidare / Consolidation		Consolidare / Consolidation		Consolidare / Consolidation		Consolidare / Consolidation		Consolidare / Consolidation		Consolidare / Consolidation		Consolidare / Consolidation		Consolidare / Consolidation		Consolidare / Consolidation	
Sanit string Open channel left		Lungimea, m Distance, m		Lungimea, m Distance, m		Lungimea, m Distance, m		Lungimea, m Distance, m		Lungimea, m Distance, m		Lungimea, m Distance, m		Lungimea, m Distance, m		Lungimea, m Distance, m		Lungimea, m Distance, m		Lungimea, m Distance, m		Lungimea, m Distance, m	
Sanit drept Open channel right		Lungimea, m Distance, m		Lungimea, m Distance, m		Lungimea, m Distance, m		Lungimea, m Distance, m		Lungimea, m Distance, m		Lungimea, m Distance, m		Lungimea, m Distance, m		Lungimea, m Distance, m		Lungimea, m Distance, m		Lungimea, m Distance, m		Lungimea, m Distance, m	
Declivitate, % Gradient, %		Declivitate, % Gradient, %		Declivitate, % Gradient, %		Declivitate, % Gradient, %		Declivitate, % Gradient, %		Declivitate, % Gradient, %		Declivitate, % Gradient, %		Declivitate, % Gradient, %		Declivitate, % Gradient, %		Declivitate, % Gradient, %		Declivitate, % Gradient, %		Declivitate, % Gradient, %	
Cota fundului, m Elevation, m		Cota fundului, m Elevation, m		Cota fundului, m Elevation, m		Cota fundului, m Elevation, m		Cota fundului, m Elevation, m		Cota fundului, m Elevation, m		Cota fundului, m Elevation, m		Cota fundului, m Elevation, m		Cota fundului, m Elevation, m		Cota fundului, m Elevation, m		Cota fundului, m Elevation, m		Cota fundului, m Elevation, m	
Cota axei, m / Finished carriageway level, m		Cota axei, m / Finished carriageway level, m		Cota axei, m / Finished carriageway level, m		Cota axei, m / Finished carriageway level, m		Cota axei, m / Finished carriageway level, m		Cota axei, m / Finished carriageway level, m		Cota axei, m / Finished carriageway level, m		Cota axei, m / Finished carriageway level, m		Cota axei, m / Finished carriageway level, m		Cota axei, m / Finished carriageway level, m		Cota axei, m / Finished carriageway level, m		Cota axei, m / Finished carriageway level, m	
Cota teren, m / Ground level, m		Cota teren, m / Ground level, m		Cota teren, m / Ground level, m		Cota teren, m / Ground level, m		Cota teren, m / Ground level, m		Cota teren, m / Ground level, m		Cota teren, m / Ground level, m		Cota teren, m / Ground level, m		Cota teren, m / Ground level, m		Cota teren, m / Ground level, m		Cota teren, m / Ground level, m		Cota teren, m / Ground level, m	
Distanța, m / Distance, m		Distanța, m / Distance, m		Distanța, m / Distance, m		Distanța, m / Distance, m		Distanța, m / Distance, m		Distanța, m / Distance, m		Distanța, m / Distance, m		Distanța, m / Distance, m		Distanța, m / Distance, m		Distanța, m / Distance, m		Distanța, m / Distance, m		Distanța, m / Distance, m	
Punct / Survey station		Punct / Survey station		Punct / Survey station		Punct / Survey station		Punct / Survey station		Punct / Survey station		Punct / Survey station		Punct / Survey station		Punct / Survey station		Punct / Survey station		Punct / Survey station		Punct / Survey station	
Elemente plan / Plan elements		Elemente plan / Plan elements		Elemente plan / Plan elements		Elemente plan / Plan elements		Elemente plan / Plan elements		Elemente plan / Plan elements		Elemente plan / Plan elements		Elemente plan / Plan elements		Elemente plan / Plan elements		Elemente plan / Plan elements		Elemente plan / Plan elements		Elemente plan / Plan elements	
Kilometri / Kilometers		Kilometri / Kilometers		Kilometri / Kilometers		Kilometri / Kilometers		Kilometri / Kilometers		Kilometri / Kilometers		Kilometri / Kilometers		Kilometri / Kilometers		Kilometri / Kilometers		Kilometri / Kilometers		Kilometri / Kilometers		Kilometri / Kilometers	

Terrain data

30 31 32 33 34

1 - 4.16

32

33 34

25 25



SECRETUL RAIONAL SOROCA
REPUBLICA MOLDOVA
CONSILIUL RAIONAL SOROCA
COPIA ESTE CONFORMA
CU ORIGINALUL
secretar al Consiliului Raional Soroca

Legenda

- ① Rambleu de sol: beton asfaltic piatra sparta argila nisipoase p.33v EGC-I
- ② Argila nisipoase, profoase, p.33v. EGC-II

Stareea solului Состояние грунта	Argila nisipoase, argila
	solid
	semisolid

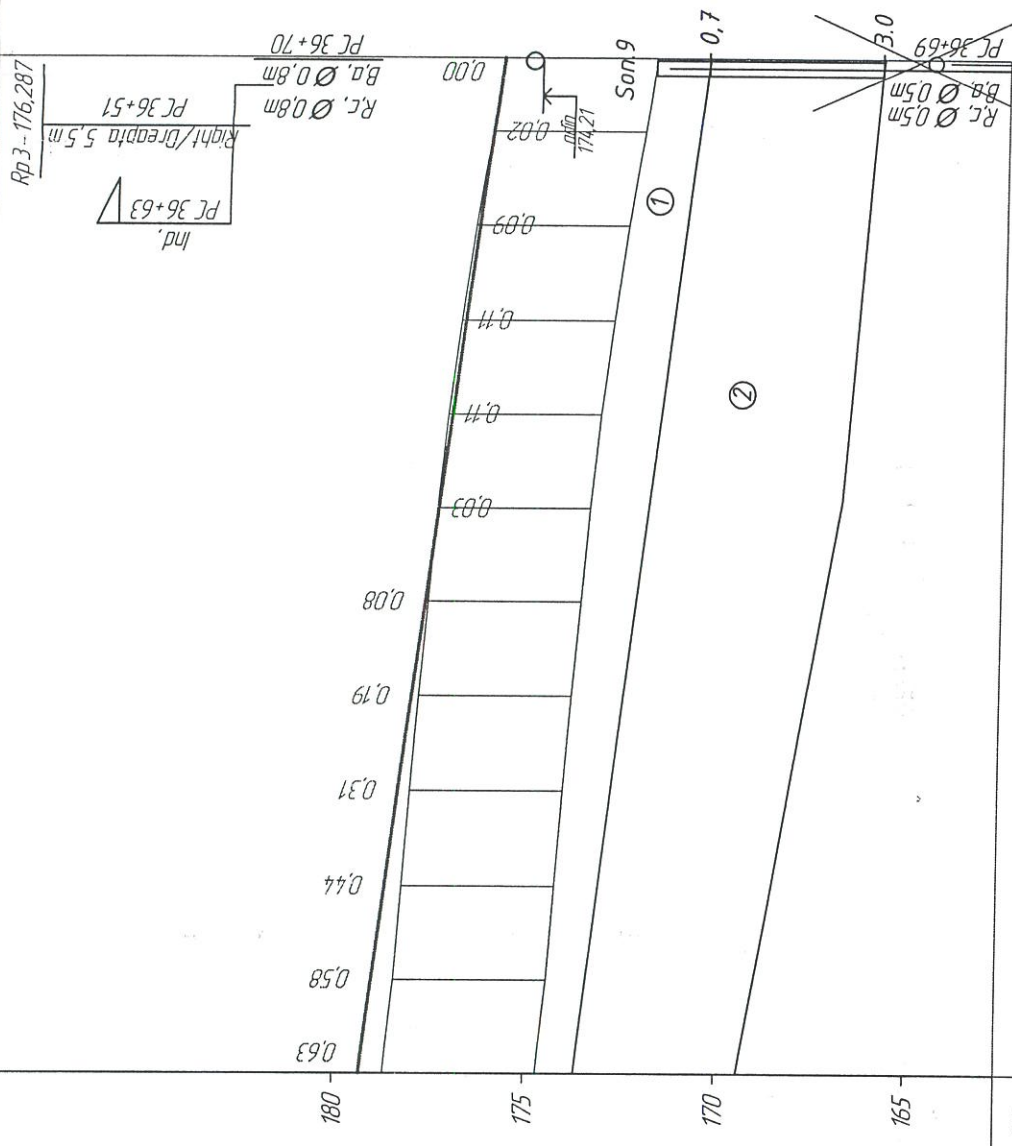

Sc 1:2000 - pe orizontala
Sc 1:200 - pe verticala
Sc 1:100 - sol

Tip profilului dupa umeditate / Profile type after humidity		Type 1	
Tip profilului transversal / Typical Cross-section		Type 3	
Sant sting Open channel left	Consolidare / Consolidation		
	Lungimea, m Distance, m	12	25
Sant drept Open channel right	Consolidare / Consolidation		
	Lungimea, m Distance, m	12	45
Cota fundului, m Elevation, m		178.41	178.74
		177.86	177.55
Declivitate, % curbă, m Gradient, % vertical radius, m		177.28	176.97
		176.66	176.35
Cota axei, m / Finished carriageway level, m		177.91	177.74
		178.05	177.43
Cota teren, m / Ground level, m		178.23	177.22
		178.41	176.80
Distanța, m / Distance, m		178.67	176.49
		178.99	176.18
Pictet / Survey station Elemente plan / Plan elements Kilometri / Kilometers		179.30	175.93
		179.30	175.93

L - 369

34

36